

## Elegant Tree JND350 -- by John Lockwood

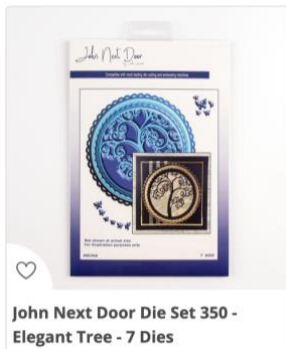

Instructions compiled by June Smith.



As always, I would recommend that you read the instructions through to the end before you commence any project.

John has created a 'You Tube' for the 'Postage Happy Birthday dies', dated 2<sup>nd</sup> June 2023, I would advise that you visit the video, as well as following these instructions.

**June's Tips:** This applies to any die, place your pieces onto your cutting plate at an angle, this helps to cut the dies in one pass. Also use your glue eraser to remove any unwanted marks.

**Information:** Die no 4 in the set is a very fine die, so just be careful when you use it

- 1 – Scalloped Outer Die
- 2 – Dotted Outer Die
- 3 – Inverted Scalloped Die
- 4 – Very Fine Circle Die
- 5 – Tree Die
- 6 – Single Butterfly Die
- 7 – Butterfly Flourish Die

### Materials

Postage Happy Birthday JND350 (7)

Mallow Flower Die JND346

Craft Artist Matt Black Card

Craft Artist Satin Black Card

White Card cut to 5 $\frac{3}{4}$ " x 5 $\frac{3}{4}$ ".

Piece of Wax Paper cut to 5" x 5".

Crafts Too Foiling Sheets

Double-Sided Adhesive Sheet 5 $\frac{1}{2}$ " x 5 $\frac{1}{2}$ ".

**Junes Tip:** I am following the video as I am typing these instructions, but when we get to the Black card with a foiled circle on it (see photo below), John had already prepared this beforehand. I had a light bulb moment!! - when you get to the white card and the double sided adhesive sheet (2<sup>nd</sup> item), if you make the white card 6 $\frac{1}{4}$ " x 6 $\frac{1}{4}$ " and the double sided adhesive sheet 6" x 6", add your foil in the same way, then when you get to cutting the foiled circle out, if you use die no 2 and 4 together, you will end up with the foiled circle, which goes behind the tree and a foiled circle frame, which you can then adhere onto the 5 $\frac{1}{2}$ " x 5 $\frac{1}{2}$ ", black matt card. Of course, it is up to you if you want to do it this way. You will also need to make and cut out some Mallow flowers, again using the foiled card.



### Method:

- Cut your Satin Black card to 5 $\frac{1}{2}$ " x 5 $\frac{1}{2}$ ", the die is very delicate so we are using a piece of wax paper cut to 5" x 5" add this over the black card, this will then capture all the little die cut pieces as they are cut out, it is much easier to get them out of the die this way, (personally I use this method all the time). Add your Circle die on top, secure with repositionable tape, and run through your die cutting machine. You can see in the photo below how lots of the piece have already fallen out, so you are not sitting there for ages poking them all out.
- We then add a piece of foiled card behind the tree so you can see how beautiful this will look and how it makes the tree pop. To do this we need a piece of white card cut to 5 $\frac{3}{4}$ " x 5 $\frac{3}{4}$ ", and a piece of double-sided adhesive sheet cut to 5 $\frac{1}{2}$ " x 5 $\frac{1}{2}$ ". Peel the backing shiny side off and add this onto your white card. Use your fingers to press it down so you cover all of sticky area, use the torn pieces to fill in the blank areas, you may need another sheet or part of one. Any excess pieces of foil you can put back into the foiling pages

for another time, I keep mine in a clear bag so that if any fall out they don't go everywhere. Beware, if you use one of those rub it scrub it sponges you can easily scratch the foil, which is why we use our fingers. Use your desk Hoover to collect any small pieces from your tabletop.

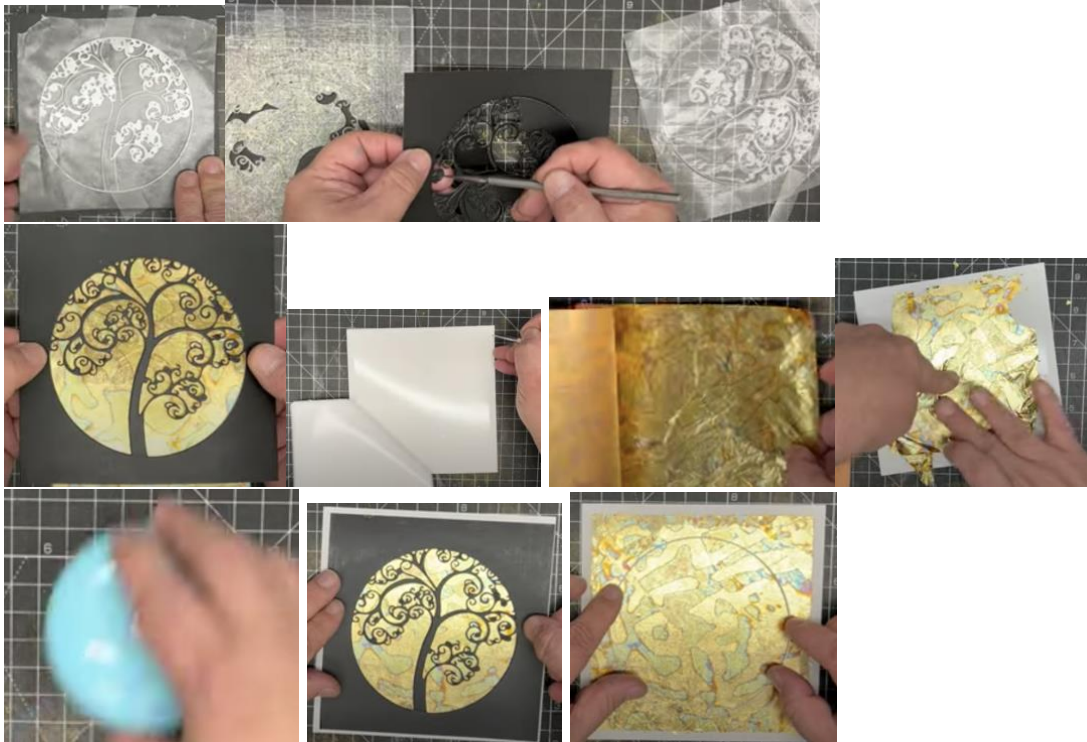

- If you place the black tree over the foiled square, you can see how this will look, but we don't want to waste the foil bits that are hidden so we take the fine circle die no 4 and place over the middle of the foiled card, secure it with removable tape and run through your die cutting machine. We only need the circle cut out, but don't waste the foiled square piece because we will use that for another project.

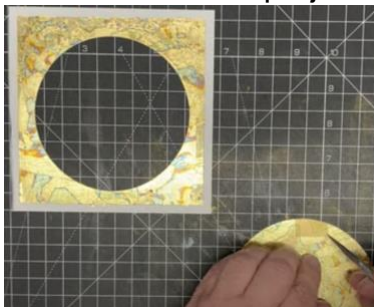

- Add spray glue to the back of the black tree and add onto the foiled circle.



- Cut a piece of the Matt Black card to 5½" x 5½", John has already added a foil circle onto this, add foam tape to the back and adhere this onto the front of your tree, if there is any black card sticking out from the back then use your scissors to undercut at an angle to cut the excess off.
- John has already prepared a black card base with a black and gold square mat and layer ready to have the tree piece added onto it.



- Cut a piece of white card to 4" x 5½", add a piece of double-sided adhesive sheet cut to the same size, add the foil onto it (the same as we did earlier), then using the Mallow Flower die plate cut out some flowers. You can then mould the flowers and add a black gem into the centre of them and arrange around the circle, your card is then complete.



I hope you have enjoyed these instructions.