

## JND409 – Sam’s Snowflakes -- by John Lockwood



Instructions compiled by June Smith.



John has created a 'You Tube' video using the new Sam’s Snowflakes die set, dated 21<sup>st</sup> July 2023. I would advise that you visit it as well as following these instructions through to the end before commencing the project.

**June’s Tips:** This applies to any die, place your pieces onto your cutting plate at an angle, this helps to cut the dies in one pass. Also use your glue eraser to remove any unwanted marks.

### Information:

Die 1 – Outer Stitched cutting die 6” x 6”.

Die 2 – Inner Snowflake Frame Panel.

Die 3 – Inner cutting die.

Die 4 - Centre Square Panel - 3<sup>3</sup>/<sub>4</sub>” x 3<sup>3</sup>/<sub>4</sub>”.

Die 5 – Circle cutting die.

Die 6 – Centre Snowflake Circle Panel. (this has been sized to fit the Sam’s Bauble die in this range so you could use this die to make the bauble up, or even use the other way round by adding one of Sam’s baubles into die no 4 to make another card).

### Materials:

2 x Kraft Card Blanks measuring 5<sup>1</sup>/<sub>4</sub>” x 5<sup>1</sup>/<sub>4</sub>” (13.5cm x 13.5cm).

JND409 Sam’s Snowflakes (6)

Helens Holly die set.

Poinsettia die set.

Craft Artist Rose Gold Satin Card  
Craft Artist Rose Gold Gloss Card  
White Pearl Dimension  
A5 Die Cutting machine.  
Pinflair  
Craft Kit

**Method:**

- Make the top fold first by creasing it down, then open it up and add onto the front of the card die no. 4 evenly all the way around, tape it down and run through your die cutting machine.
- Then take another card blank and this time add die no. 5 to the centre and cut that out. We only need the circle for our card today, but the 2<sup>nd</sup> card blank can be used for another project. You can see an example of one below that John made using rose gold satin card on the front.

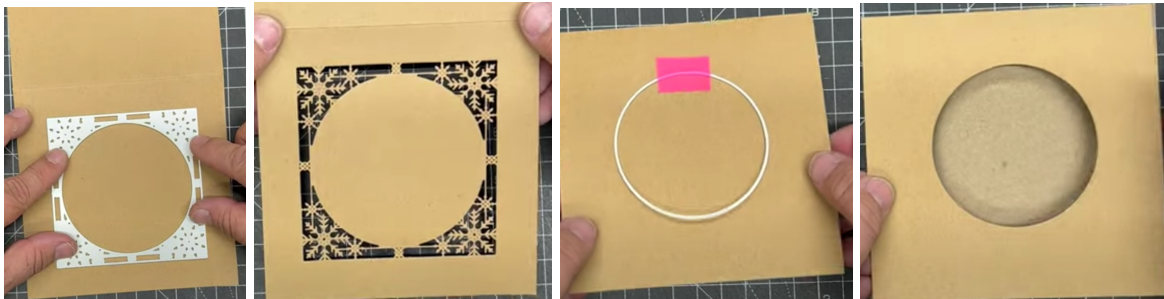

- Using the cut circle add die no 6 to it and cut that out.
- Then using Rose Gold Satin cut out die no 5 from it.
- Cut a strip of the Rose Gold Gloss card to 1¼” wide.
- Take the decorative circle you cut out earlier, spray the back of it and add the Rose Gold strip across it. Then take the Rose Gold Satin Circle and add this on top of the strip, it will stick because you sprayed the circle just now. You could take your circle die, drop it back on and cut the circle out, or use a pair of scissors to cut around it. Add 3 pieces of foam tape separately onto the back, remove the yellow backing and add this onto the front of your card. You could have the panel going across or down the card – your choice.

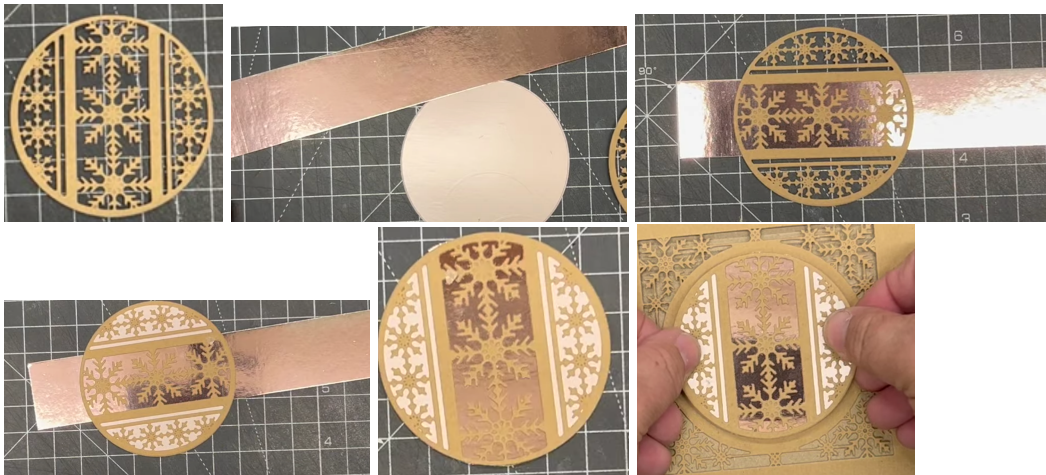

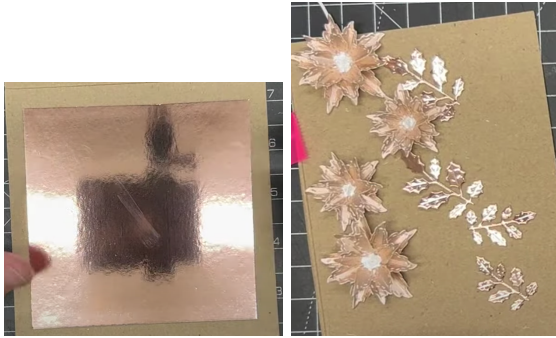

- Cut a square of Rose Gold Gloss card 4<sup>3</sup>/<sub>4</sub>" x 4<sup>3</sup>/<sub>4</sub>", add wet glue to the back and adhere this inside the card, when you then close the card up you can see the gloss card showing through.
- All we need to do now is to decorate the front of our card. Using the Satin and Gloss Rose Gold card, cut out the poinsettias in Satin and the holly from the Gloss card. Shape and layer up your flowers using either Pinflair or wet glue.
- Now using Pinflair add the holly and one Poinsettia onto your card front.
- Finally, to finish off add some of the Silver Pearl Dimension onto the centre of all of the snowflakes and if you want into the centre of the Poinsettia.



Your Card is now Complete. I hope you have enjoyed these instructions.