

JND414 Twist Cracker Box -- by John Lockwood



Instructions compiled by June Smith.

As always, I would recommend that you read the instructions through to the end before you commence any project.

John has created a 'You Tube' video demonstrating how to make a box for the New Twist Cracker, dated June 2023, I have created an instructions document showing how this was made. I would advise that you visit them as well as following these instructions through to the end before commencing the project.

Materials:

A4 Sheet of Emerald Gloss Card
A4 Sheet of Snow Acetate
Scoreboard
Blue Powertape.

Method:

- Trim one of the Mirror sheets to 8" x 11½" – Place onto your Scoreboard and score down at 1¼" on all 4 sides.
- With the mirror side facing you, crease all 4 folds. Then take a pair scissors and snip up to the fold line, then move the scissors slightly so you can cut out a little wedge. Repeat this on all 4 sides.

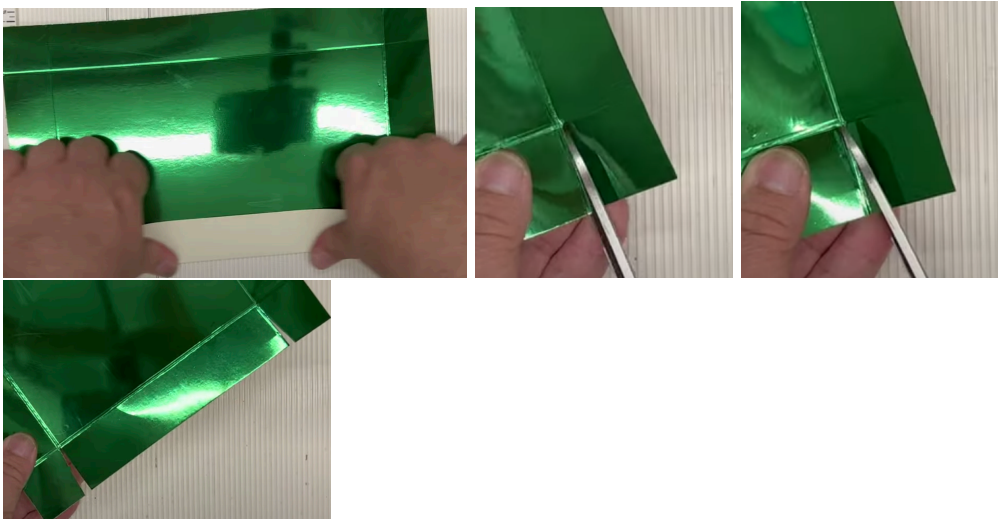

- Add Power Tape on the front of all 4 sides. Remove the blue cover tape and because we want to see the inside of this box, the flaps need to go on the outside. You can then see that the crackers fit perfectly inside.

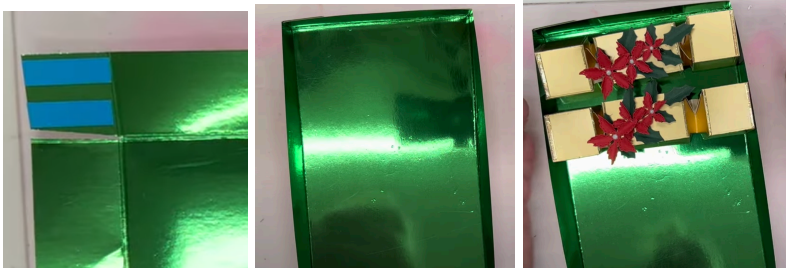

- Bring in your Snow Acetate, (depending on the made of the Acetate you may find that there is a film covering it, if so we need to peel that off first). This is exactly A4 in size and we make no changes to this at all. Bring back in your Scoreboard and this time we will use a pokey tool, (you will find that a bone folder will not score the acetate deep enough). Score down on all 4 sides at 1¼". Cut the 4 notches on all 4 corners exactly the same as we did on the green mirror base – then add powertape as we did before. Remove the blue covering and fold the corners over.



- You now have a lid for your box. You can add some ribbon around the box and make a lovely bow to decorate it. Also, you could add some Poinsettia and Holly – the choice is yours. See John's Box below with the 6 crackers inside.





- If you wanted to make a box with 4 crackers inside, you would cut the base card to 8" x 8" Square and score at 1¼" all the way around. Then for the Acetate lid you would cut it down to 8¼" x 8¼" and make it up the same way.



I hope you have enjoyed these instructions.