

JND390 – Mistletoe Bells - by John Lockwood



Instructions compiled by June Smith.



John has created a 'You Tube' video using the above-mentioned dies, dated 3rd August 2023. I would advise that you visit them as well as following these instructions through to the end before commencing the project.

Information:

This is such a beautiful shaker card, why not join in with these instructions. This die set doesn't have a square outside cutting edge, but there are square dies from the 2023 Christmas collection that will fit.

Die 1 – Is an inner cutting die $4\frac{7}{8}$ " x $4\frac{7}{8}$ " surrounded with Mistletoe.

Die 2 - Is the outside of the top bell (see picture above)

Die 3 – is the inside Bell, which has ivy on it with a cut out piece on the top.

Die 4 – is the outside on the bottom bell (see picture above)

Die 5 – is on the bottom of magnetic sheet it has a large snowflake in the middle.

Dies 6 & 7 are left and right facing sprigs of Mistletoe.

Preparation: Matt & Layers:

Your white card blank is $7\frac{7}{8}$ " square.

Christmas Green Card cut to $7\frac{1}{2}$ " square.

White Coconut Card cut to $7\frac{3}{8}$ square.

Gold Satin Card cut to 7" square.

Coconut White card cut to $6\frac{7}{8}$ " square.

All layers are using wet glue.

Materials:

8" x 8" Top Folding White Card Blank

JND390 – Mistletoe Bells (7)

Circle Die no 3 - (5" circle) from the Pear Tree Bauble JND395 (12)

Craft Artist Christmas Green Card

Craft Artist Coconut White Card

Craft Artist New Gold Satin Card

Craft Artist Crystal Ice as the shaker elements.

Craft Artist Crystal Snow which is a bit chunkier.

Kaleido Acetate or similar.

Green & White Bakers Twine.

Easy Squeeze Super Tacky Glue.

Craft Artist Pearl Dimension in White, Red, or Silver.

Glue Glaze

Craft Artist Gold Metallic bells (need 3)

Craft Kit

Method:

- Cut a piece of the Christmas Green card to 5³/₄" x 5³/₄", place die no 1 onto the centre, tape it down and run through your die cutting machine, turn it over and check that it has all cut out, if not rotate the card and run through again.
- As this is going to be a shaker card we need to block out the 4 corners otherwise the shaker bits will fall out all the time ha ha, yes they will. So, bring in the circle die from the Pear Tree Bauble set which fit's exactly over the Mistletoe and add this to a 5¹/₂" x 5¹/₂" square piece of New Gold Satin Card, tape it down and cut out. You will have a spare circle for another project. Spray glue the back of the green piece and add this exactly onto the satin gold frame. We then need some Kaleido Acetate, spray glue the back of the frame and add onto the acetate, trim down any excess.

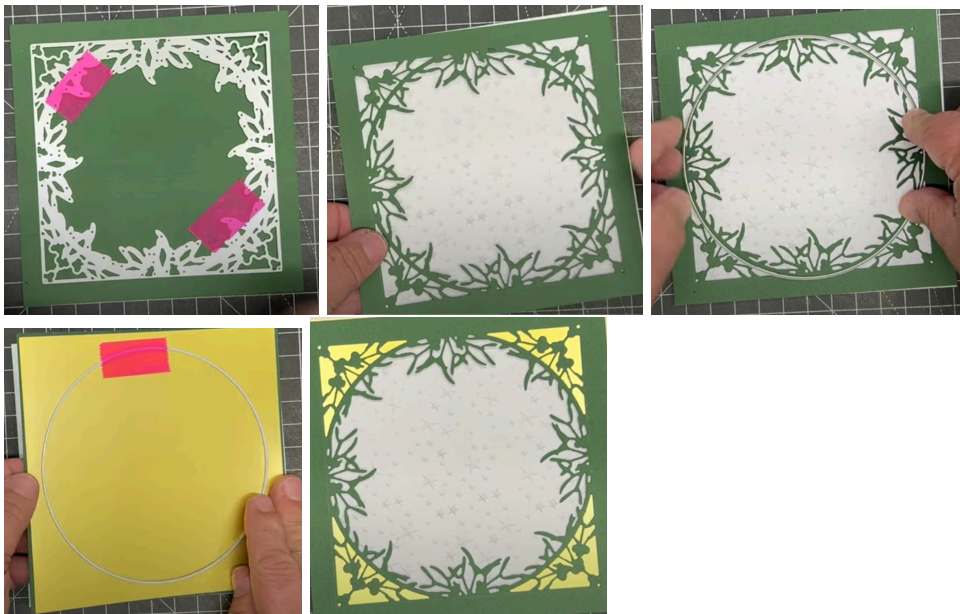

- Now to prepare and add the shaker element. Turn the piece over so face down, add 2mm foam tape around the outside and also 4 pieces in each

corner. Then bring in the Crystal Ice and add some into the middle. Also add some of the Crystal Snow which is a little bit chunkier. You could use sequins or something similar.

- Remove all the yellow backing, including the corners. Cut a piece of Coconut White card and emboss it with a star embossing folder (coming soon), or similar, then add this evenly onto the card. The shaker bit is complete. Information: by not raising the foam tape higher and adding a nice lot of shaker elements they don't all fall to the bottom of the card. Use your scissors at an angle to undercut any excess.



- Add foam tape around the back of the card and take the yellow backing off of one side only, it doesn't matter which side it is as they are all the same.
- Using John's tape trick of taking a long piece of pink tape, pick up the inner die and hover over the outer die until it is even and press down with the outside handles (this is so much easier than trying to get the 2 dies even by eye). Repeat this for both bells and cut out from a scrap of the Gold Satin Card. Then using the outside dies only cut the backing bell out of a scrap of Coconut White card. Add spray glue to the back of the gold bells and add onto the corresponding background white bell (they are slightly different size bells so make sure you have the correct on).
- Take a piece of Bakers Twine (obtainable from Art of Craft) and secure it with one piece of foam tape on the back of one bell. And 2 strips on top of each other onto the other bell. Using your fingers mould the bells slightly to create a dome shape in the middle.

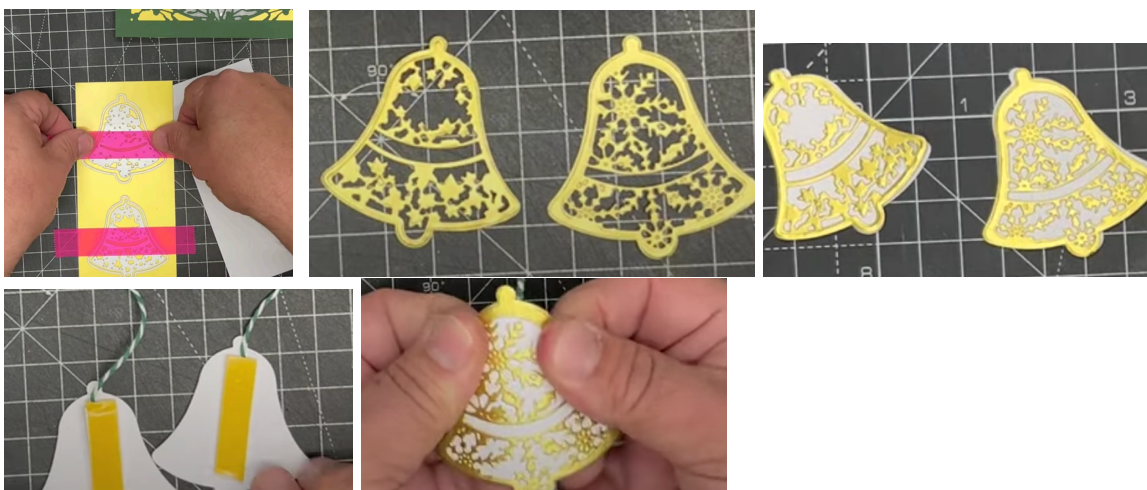

- Check the back of your main card so that the sticky foam is at the top, then take the bell that has 1 strip in the middle of the bell, remove the yellow backing and place near the bottom left of your card, bring the twine up over the centre top of the card and press down onto the sticky foam. We then repeat this for the other bell but this time we will add it a little bit higher and on

the right-hand side overlapping a bit from the first bell. Take the twine up to the top centre, fold over and press onto the sticky foam.

- Snip off any excess twine. Bring in your base mat and layered card, make sure it is top folding, remove the yellow backing tape from the back of your front piece and add onto the layers.

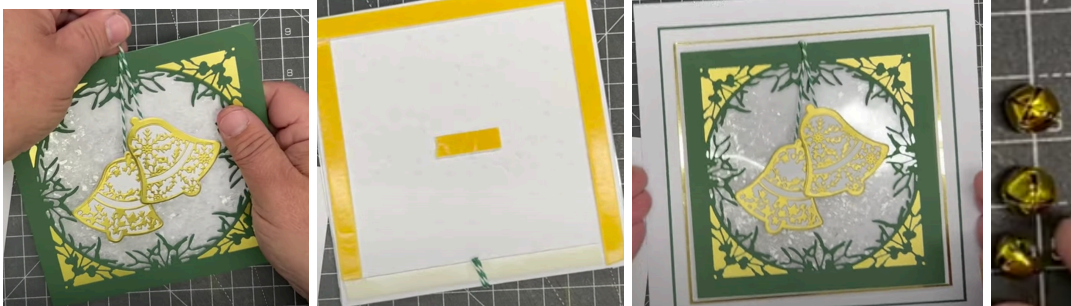

- Using the twine make a bow, add Pinflair on the back, add onto the top middle of the card where the twine was crossed over. Then add a small bit of Pinflair onto the knot of the bow, add on one of the gold bells. Then add a small dab of Pinflair onto the top of the gold bells where the twine comes out and add a gold metallic bell onto both.
- Finally using white Pearl Dimension, small white flat back pearls or similar onto all of the mistletoe areas, and your card is complete.



I hope you have enjoyed these instructions.