

JND421- Joys Trees – 3D Card – by John Lockwood

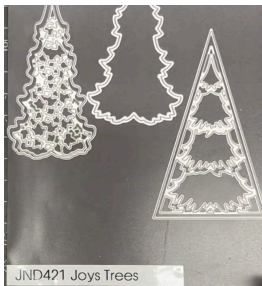

Instructions by June Smith



On this 'YouTube' video dated 28th June 2023, John demonstrates how to make this beautiful 3D card using the Joys Trees Insert Dies. I would advise that you visit it as well as following these instructions.

Materials

5" x 7" White Card
JND421 Joys Trees (5)
Stars Embossing Folder (coming soon)
A5 Die Cutting Machine
CA Essential Christmas Green Card
CA Essential Coconut White Card
CA Emerald Green Gloss Card
CT Green/White Stripped Satin Ribbon
3 Green CA Bells
CA Glue Glaze
2mm Foam Tape
Pinflair
Craft Kit

Method:

- Cut a piece of the Coconut White card to 4" x 6". Tape down the outside cutting triangle evenly onto it and run through your die cutting machine.

- Then run that through your Stars Embossing Folder,

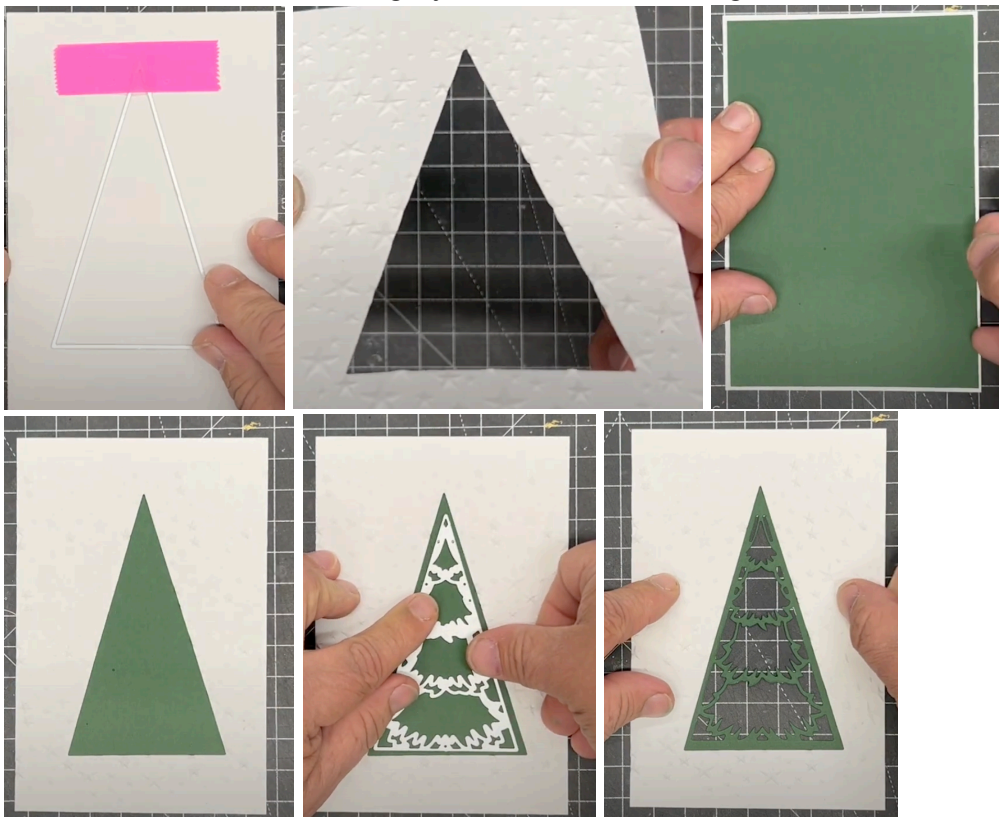

- Cut a piece of the Christmas Green card slightly smaller 3¾" x 5¾", so that it doesn't show around the outside and place behind the white triangle piece. Then take the tree die and place into the middle, tape it down, remove the white piece and run that through your die cutting machine.
- We then take the remaining tree outline die and cut this out from a piece of the Emerald Green Gloss card. We then want to glue this into place on the back of the main green tree, the best thing to use for this is CA Glue Glaze, it dries very quickly and strongly. Turn the Green card over and run the wand along the middle bits of the tree branches, see photo below. Then add your green gloss card onto it.

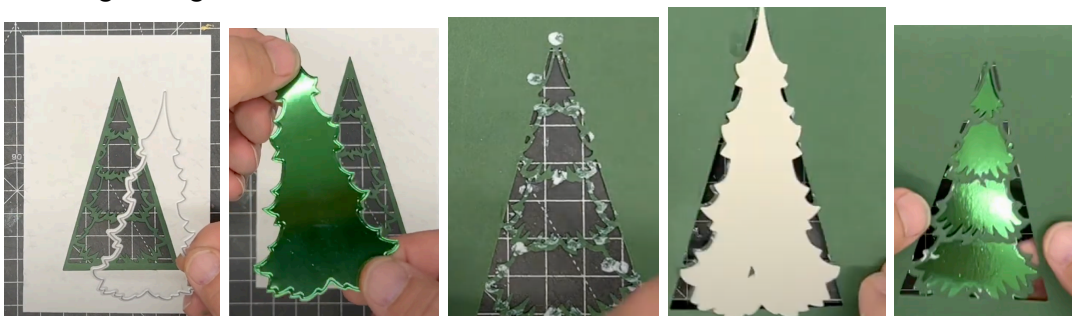

- Take the 2mm foam tape and add this around the inside of the embossed white panel and a couple of bits near the top of the triangle to support it. Remove the backing and add onto your beautiful tree.

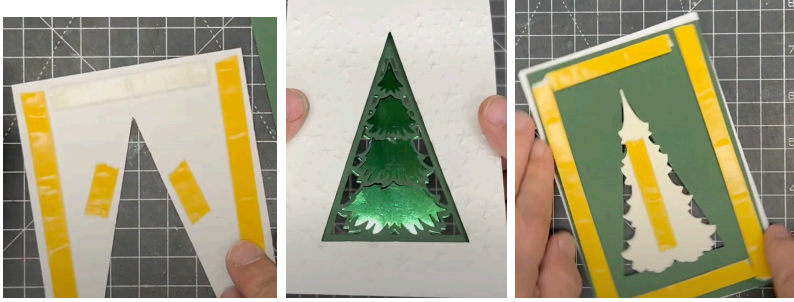

- Turn your card over and add foam tape onto the back and a piece down the middle of the tree to support it. Remove the backing from the 2 sides only as we are going wrap around some of the grey/white satin ribbon near the bottom. Remove the rest of the backing tape and add this to a 4½” x 6½” piece of Green Card. Add wet glue to the back and adhere straight onto your top folding white card blank.

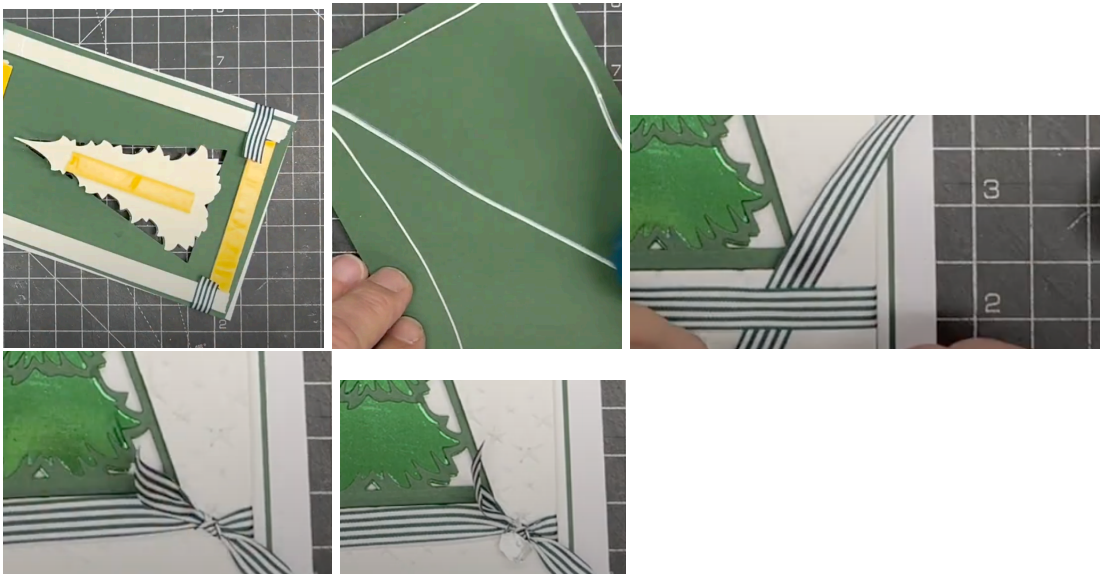

- Take another piece of the ribbon and pass it under the ribbon already on the card front (this is why we don't stick the ribbon all along the front of the card). Tie a knot and snip off the ends at an angle to make fishtails.
- Take a little bit of Pinfair and add this just below the knot and add onto it 3 green bells.



Your creation is now complete. I hope you have enjoyed these instructions.