

Preparation:

You will need to cut out **5** pieces of Kraft Card and **5** of White card to 12.5 cm square (or slightly under 5")

Materials

Kraft Card

CA Essential White Card

JND392 Diorama Die (1)

JND419 Deer Scenes 2023 (9)

JND Christmas Special Project Book Kit

Winter Trees Embossing Folder.

New Fusion Ink Micra Magic

A5 Die Cutting Machine

CA Blue Powertape 6mm

2mm Foam Tape

Craft Kit

Method:

- Take one of the pre-cut kraft card which are 12.5 cm square (or slightly under 5"). Emboss this using the Winter Trees Embossing Folder from the new JND Christmas Special Project Book. You should find that the card has the stunning impression on it.
- Then using the new Fusion Ink Micra Magic, rub over the embossed areas using Bronze, Black, Gold and Lychee colours, so that your design looks like the photo below.

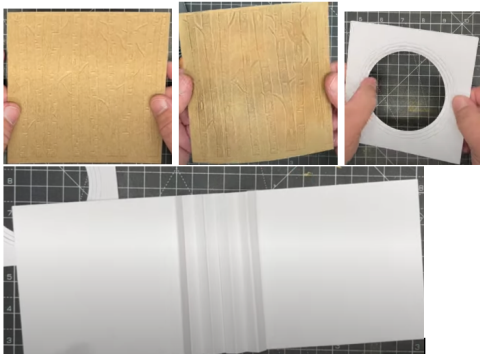

- From the 5 pieces of white card, you need to cut out the circle dies to make concentric circles in each one, this means you use a circle die on them so that each piece has a smaller circle cut out of it than the one before, until you have 5 circles cut out. If you imagine when you drop a pebble into water you get ripples of circles, well these are called concentric circles (I never knew they were called that either!). We will be putting a different element behind each one of these. **Tip:** I find it easier to use a pencil and number them on the back, just in case I get them mixed up.
- From White Card cut out and make up the Diorama die and adhere them together to make your book covers. There is a separate You Tube video dated 27/9/2023 called 'JND392 – Diorama Die', & instructions, which are placed onto the group Facebook page for you to access at your leisure.

- We start by using wet glue onto the back of the square kraft card panel that you coloured earlier, turn it over and adhere onto the right-hand back panel of the book.



- Take the 5 white circle pieces you have just cut out, and starting with the smallest circle we are going to adhere this onto the spine in front of the kraft card back panel using wet glue.

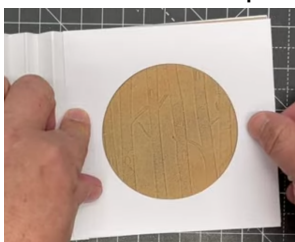

- Take another piece of the pre-cut kraft card, take both of the Split Trees dies and lay them evenly onto the card making sure that where the dies meet at the top is evenly aligned, tape them down using the new pink repositionable tape, and run through your die cutting machine.
- Where the two tree dies met you will see that the middle has not fully cut out at the bottom from some of the trees, this is correct so all you do is take a pair of scissors and snip them off.
- Bring in a spare piece of card, lay the die cut piece onto it, and using the Micra Magic, same colours as before, pick up a bit on your finger and go over the trees. You can see this better on the video.

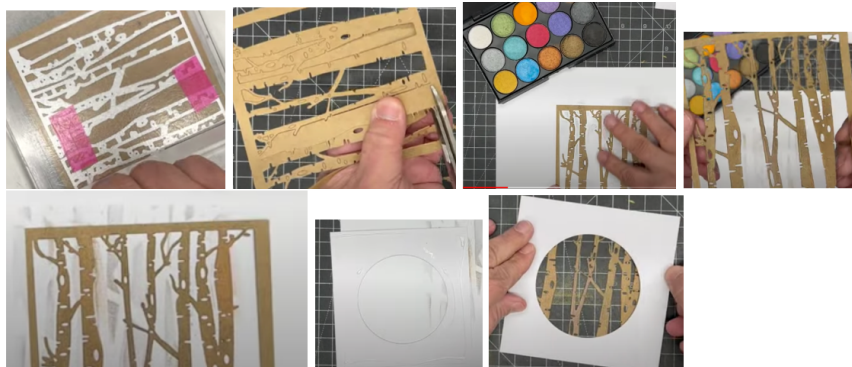

- Take the white square cards with the circles cut out of them and using the smallest cut circle, turn it over and on the back run a little bit of CA Super Tacky Glue around the edge of the circle and also the outside of the square, (it is not advisable to use spray glue for this). Turn it over and marry onto the trees.
- We are going to repeat this process with another pre-cut piece of kraft card, this time cutting only the larger tree die on the right-hand side, so it lines up evenly on the 3 right-hand sides. All the pieces in between the trees should

fall out, leaving a larger solid piece on the left-hand side, we simply take our scissors and cut a line up to the base of the trees both sides and we end up with the 2 end pieces on the left-hand side. Repeat the process of adding some of the micra magic as you did before.

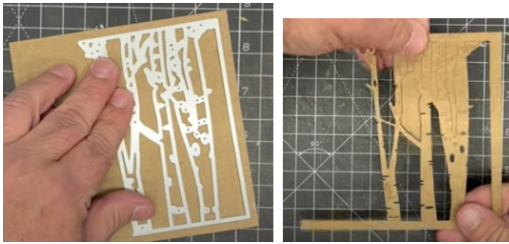

- Bring in the next white circle piece and if you just hold the trees behind it and hold it over the previous one you want to make sure that the circle is even, but the trees are slightly offset (I would add a little pencil mark behind, so I know where to position the trees once I have added wet glue to the back of the white circle) but that is my choice. We are then going to turn the white piece over and add wet glue around half of the circle and on 3 of the outsides, when you then turn it back and add onto your trees into position you can adjust it slightly if necessary because the glue is still a bit wet, trim any excess kraft card which may be sticking out. I hope this makes sense.
- If you then hold this over the previous one you can see then how this tunnel will work.



- If you now bring in one of the hill dies from the set, and place this onto a scrape of kraft card cut to the same size as before, then tape the die down and run through your die cutting machine. You will see that it has cut into the card but not either end so snip off the end of both the cut lines. Add a little bit of wet glue around the 3 straight edges and adhere onto the front of the first circle card.
- Then take the cut off waste piece, turn it over and place this onto the front of the 2nd white piece so that the hills are on the opposite side. Add wet glue on the back around the 3 sides and a little bit in the middle, then add onto the front of the 2nd layer. We are building up our little scenes.

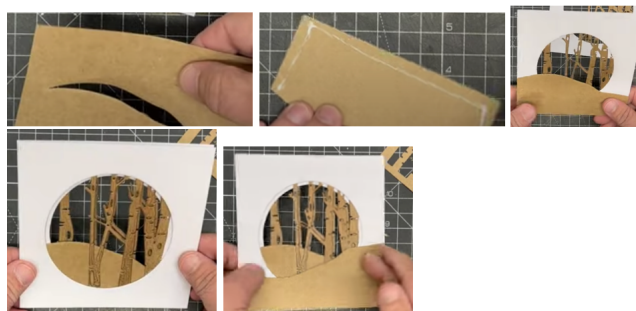

- Bring in the 3rd white layer, we are going to now add some deer. Using the larger deer die from the new 2023 die set, cut this out of the same width size of kraft card, add some of the same colour micra magic which you used earlier, to highlight colour onto both the deer. Once again place the white 3rd piece onto the front of the 1st and 2nd white circles so you know that it is still all in line. Add a little bit of wet glue onto the 3 straight edges and a bit in the middle of the bottom of the front deer piece, then bring the white circle piece and add that onto the top – before it is properly stuck just position it over the other layers to make sure it is right, then you can press it down firmly. Bring in the back piece and you can see how that will look when it is put together.

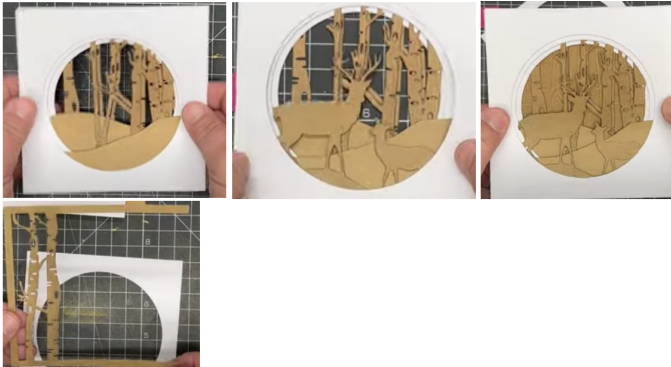

- Take the final piece of pre-cut kraft card, cut out in the same way as previously but this time just using the narrow 2 trees die. As previous, add the same colours of micra magic to these. Cut all the solid piece up to the edge of the trees. Add wet glue just around the 3 edges and place the white circle layer onto it. When you add this on top of the others it should look as below.
- John has then got a final piece of Kraft card cut with the hill die, added wet glue to the back of the 3 sides, then added that onto the back of the white circle piece. You may have noticed that we have NOT added any of the Micra Magic onto the hills so that they show up as a different plain colour.

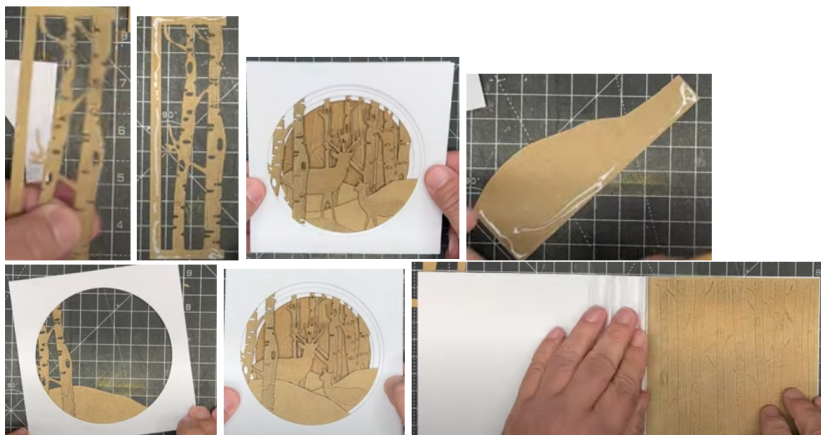

- Bring back in your book, open it up so the embossed trees are on the right-hand side. We then add 66mm Blue Power Tape or a very good quality red liner tape, nothing else is strong enough - add a strip down each of the front layers of the spine pages.
- Remove the blue backing from the bottom layer and add the bottom layer onto it, making sure that the pages are even all the way around before you stick it down securely. Repeat this so that you end up with all the pages in place.

Your tunnel card/book is then complete. You could make a wrap to go around the book to keep the pages closed.

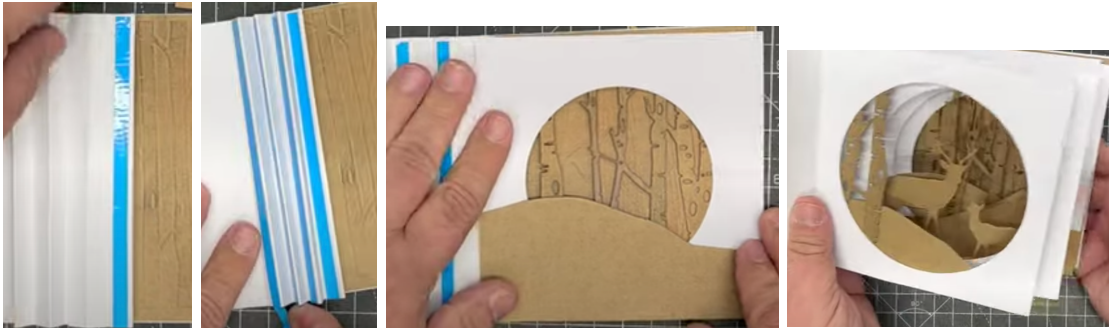

Your creation is now complete. I hope you have enjoyed these instructions.