

JND481 Sweeping Boughs- by John Lockwood



Instructions compiled by June Smith.

John has created a 'You Tube' video using JND481 – Sweeping Boughs, dated 16th June 2024, I have incorporated these in this set of Instructions. I would advise that you visit them as well as following these instructions through to the end before commencing the project.



Information:

In the die set you have 8 dies, a left and a right in 4 different sizes. These are very detailed and delicate so you will need to pay particular attention when you are cutting these.

Preparation:

You will need some of the pre-made Christmas Red Frost Flowers, Tea Hawthorne's which have red CA Pearl Dimension on all the ends.

Materials:

7" x 7" Top Folding White Card Blank
JND481 - Sweeping Boughs Die Set (8)
JND455 – 5 x 7 Frame It Die Set (15)
JND479 - Frost Flower
JND460 - Hawthorne (4)
JND483 – Argyle Layer Set (just the Embossing Folder)
CA Christmas Green Card
CA Christmas Green Card
CA Silver Waterfall Card.
CA Silver Laser Glitter Card
A4 Die Cutting Machine
Clear Dew Drops
CA Red Pearl Dimension
Red & White Bakers Twine.
Craft Kit

Method:

- Place the Sweeping Bough dies going forward towards the top, onto a sheet of Christmas Green Card, it is very important that the dies are well spaced out in a vertical position, so they vet the longest time going through your machine. Also, that they are well taped down, otherwise you could damage the dies if they move whilst going through the machine. With the pink tape really burnish the tape onto the card and dies. Once they are nice and secure, place onto your metal shim and run through your A4 die cutting machine. John is using a Go Power machine which is very old and has been quite a work horse, so he is using another metal shim on top of the card. Turn it over and check on the back that all the dies have cut the card, John needs to put his through again as there are couple of places in the middle, so he is going to turn the card around, so the bottom stalks are going through first and run them through the die cutting machine. If you need to cut one or two of the dies it would be much easier. It is also easier to remove the dies and push the Boughs through from behind and they fall out perfectly.



- We are now going to add a bit of glitter to the edges of the Boughs, so place these onto a piece of card, pick up one of them and use your Glue Glaze wand to just stroke and cover over the edges of the Bough. Bring in the CA Silver Laser Glitter and sprinkle this over the Broughs. **Information:** If you look at the top of the bottle you will see a plastic cap with a hole in the centre, if you use a pokey tool to gently poke into the hole and at an angle you can then pull the plug out to put some on the paper and turn each bough over to dip into it. When you have finished, fold the paper and pour the glitter back into the bottle, replace the cap and store away. John has already made a set about 5 minutes ago and they are dry.

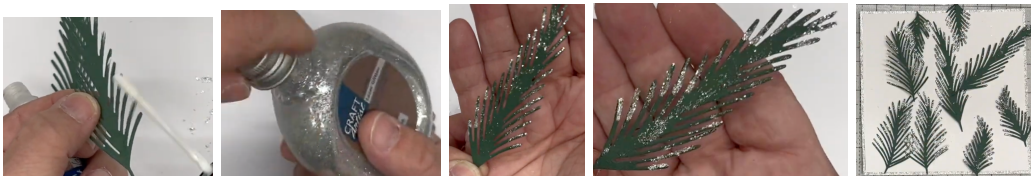

John has already prepared his base card, using the following layers (sorry I am not sure of the measurements for them).

7" x 7" White Top Folding Card Blank

Silver Waterfall Card

Christmas Red Card

Coconut White Card

Coconut White Card Embossed with the JND483 Argyle Layer Embossing Folder

Red & White Bakers Twine

Coconut White Card Cutting out dies 6-10 from the JND455 - 5 x 7 Frame It set, this will have all the holly & berries cut out on it.

Silver Waterfall card, cut Frame using die 6 – adhere this at the back of the frame.

Then add foam tape onto it, remove the foam and add onto the following piece.

Coconut White Card Cut to 3" x 5", to go behind the Frames.

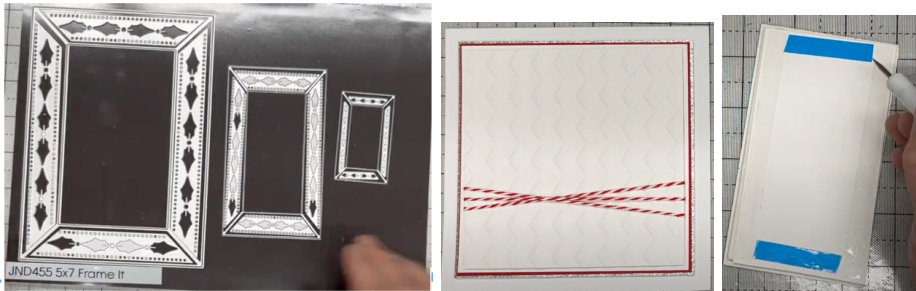

- Add blue powertape around the back and layer this towards the right side of your card front with an even border on all 3 sides.
- Cut another piece of Bakers Twine, make a loop and thread this behind the twine on the card, so the ends are even lengths. We then want to cut the loop, then tie a knot using both strands. Finally tie a knot on all 4 ends to stop them fraying and cut off the excess. Then push the knot as near to the frame as you can.
- Now to add wet glue onto the centre back of the Silver/Green Boughs and position them into place, see photo below: Then wet glue onto the back of the Hawthorns added in opposite directions. Add a couple more of the small Boughs in the centre to cover over the Tea colour Hawthorne. Finally, 3 of the Red Frost Flowers which have a clear Dew Drop in the centres.



Your card is then complete.



I hope you have enjoyed these instructions.