

JND471 Festive Houses - by John Lockwood



Instructions compiled by June Smith.

John has created a 'You Tube' video using JND471 – Festive Houses, dated 24th June 2024, I have incorporated it in this set of Instructions. I would advise that you visit them as well as following these instructions through to the end before commencing the project.

Information:

In this video John is going to show us how to make a card similar to the one below, using the Festive Houses die set which is a similar smaller version to JND458 Lantern House so you can create beautiful cards like the one below. You could also make a village of the 2 sets of houses mounted onto a board with grass and road areas, including trees, fencing etc. The house dies have flat and raised intricate areas and these have been designed to work on your foiling machines. You could also ink the die before cutting it out to give you a completely different distressed look.



Materials:

7" x 7" Top Folding White Card Blank

JND471 – Festive Houses (4)

JND460 Hawthorne (premade cut in Gold Mirror card with Pearl White Dimension on the ends of the smaller Hawthorne leaves)

JND441 Scarlett Flower (premade)

JND490 Festive Swirl Sentiments

Essential Coconut White Card

Kraft Card

Essential Burgundy Card

JND Snowfall Embossing Folder, or similar

Versafine Vintage Sepia and finger dauber

Ice White Pearl Fusion.
6mm Blue Powertape
A4 Die Cutting Machine
Press to Impress Stamping Platform
Craft Kit

Method:

- Using Coconut White card cut out the larger and small houses. Then bring in your Vintage Sepia ink pad and dauber, pick up a little of the ink and first of all go around all the sides, then without picking up any more ink go over the front of the house, so you get a softer colour which highlights the embossing and debossing from the die. Of course, you could use the Pearl Dimension to highlight the raised areas as well, John will show us that on the finished card.
- Cut the small background die from a piece of Kraft card. If you put them together it looks a bit flat so what we do is to cut 2 small piece of 2mm foam tape and cut them in half longways, you can then add a strip of it down both sides of the roof, a strip just below the top window and 2 small piece on either side of the bottom, this is a great way to use up those little foam squares you may have. Add the pieces together. You can see then that there is a little bit of shadowy shine in the windows.

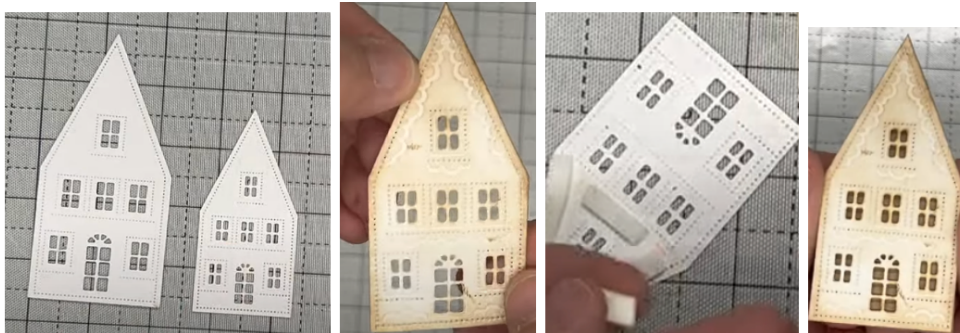

- John has already prepared a piece of one of the new frame maker dies, which if not out already will be out before the end of July 2024. This is a square frame with stitching around the outside and a circle in the middle also with stitching around the inside. He has used the same ink and dauber to give it that distressed look. Add foam tape to the back of the larger house and add this onto the bottom right-hand corner of the card. For the smaller house we want to raise this up, so it is Infront of the other one, so we add 2 pieces of foam tape on top of each other behind the left-hand side of the house and 1 piece on the right side. Remove the yellow covering and add onto the front of the card half way over the large house.

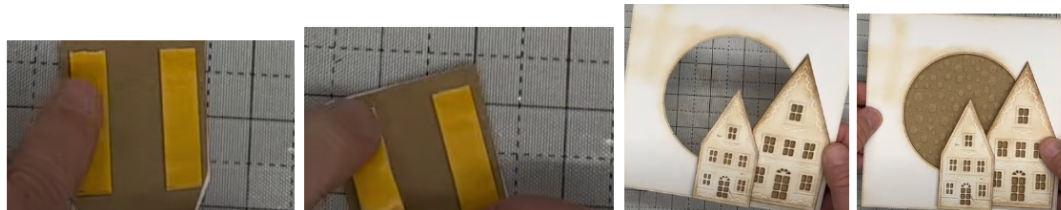

- We now need to take an A4 piece of Kraft card and place this inside your Press to Impress stamping platform, secure it with the magnets. Then bring in

your card and place that into the top left-hand corner, use another magnet to keep it in place. Then take the stamp 'From my Home to Yours' and place this inside the circle. Once you're happy close the lid and open it to pick up the stamp, remove the card, ink the stamp up with the same Versafine Vintage Sepia close the lid and press down, you could re-ink the stamp and do it again if the ink is not strong enough. Remove the card and trim this down to roughly 5¾" square. Then run this through your JND Snowfall Embossing Folder. You can see then that the sentiment is still nice and readable. Then take the Ice White Pearl Fusion ink pad and gently/lightly go over the snowfalls with the pad.



- On the back of the frame add foam tape around the outside square, also 4 little pieces around the middle circle, remove the yellow backing and adhere over the embossed backing, if there is any of the Kraft Card showing over the edge just use your scissors at an angle to undercut it. Add wet glue to the back and adhere this onto a 7" x 7" top folding card blank which has a layer of Burgundy card and Coconut White card adhered to it.



- John has got some pre-made small Hawthorne Leaves which have White Pearl Dimension on the ends. Also, a Burgundy Scarlett Flower with a white/silver glittered centre, this is perfect for Christmas cards.



Your card is then complete, I hope you have enjoyed these Instructions.