

JND483 – Argyle Embossing Folder & Stencils - by John Lockwood



Instructions by June Smith

Information:

John has created a 'You Tube Video' dated May 2024, using the new JND483 Argyle (sometimes called Harlequin) Embossing Folder & Stencil set which have been designed by John. These are a new release; in the pack you have a beautiful 3D Embossing Folder with a Diamond pattern on them. These are not like your usual EF's in as much as these are clear folders not cloudy like others are. You will see as the demo progresses how there are 2 stencils in the set which click onto the embossed card rather than you having to move it around to try and get the stencil in the correct position. John has made a beautiful card using these products, but we will be making a plain card for the purposes of these instructions which is concentrating on the techniques. I would advise that you visit it as well as following these instructions.

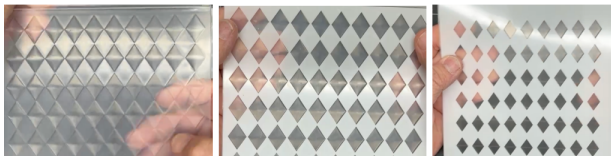

Materials

8" x 8" White Top Folding Card Blank
JND483 Embossing Folder & Stencils (2)
JND437 Folk Art Frame (13)
JND436 Delicate Frame (9)
Plain White Stamping Card
Essential Pacific Card
CA Pearl Fusion – Pacific and Verdant
A4 Die Cutting Machine
CA Coloured Dew Drop Gems
Glue Glaze
2mm Foam Tape
Craft Kit

Method:

- Cut a piece of plain white stamping card to 6" x 6" or ideally 5¾" x 5¾" which means that you can get 2 pieces out of an A4 sheet. Position this inside your EF and run through your die cutting machine. You then get a beautiful raised doomed diamond raised up in the design.
- We will then bring in the larger patterned stencil. We can use our press to impress stamping platform to secure the card and stencil into the correct position and tape it down so that it doesn't move, or as John has done for the video, tape the card down onto his table top using the grid lines to get it even and add the stencil onto it, you will notice that the stencil slots onto the raised embossed areas almost clicking into place which is going to make it so much easier to work with. Tape the stencil down along the top and bottom (you could do the sides as well if you wanted too) using your tape. We will then be using some of the Fusion Pearl inks.



- You may find that it is easier to use brushes to add the inks onto your stencil because any stencil could rip the foam on the end of your blending tool, but this is entirely your choice. John is using the blending tool for speed. Cover all over the stencil with the Pacific Pearl Fusion. Then when you lift the stencil off the ef you can see the depth of the design and how the ink has covered the correct places.
- We are then going to add the smaller pattern stencil over the design, tape this down and go over it with the Pearl Fusion Verdant. When you then remove the stencil you can see the amazing colour but with a white edge around every diamond rather than them merging together.

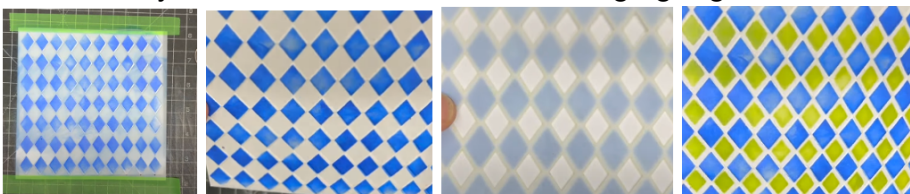

- We then want to make a frame for the design using the same stencils, so bring in another A4 sheet of normal stamping card, position this landscape across the top and place the larger patterned stencil into the top left-hand corners, pick up the Pacific Fusion again on your dauber or brush and go over the top left-hand corner to about half way down, very lightly so the pattern appears to fade. Then because the stencil has a repeating pattern on it we can remove the stencil and matching up the pattern add it down to the bottom of the card, then add some of the dauber over it. We are then going to remove the stencil and matching up the pattern again add it further over towards the middle and randomly add some ink down the right-hand side of the stencil. Repeat this to move the stencil down, again matching the pattern and repeat further down on the card.

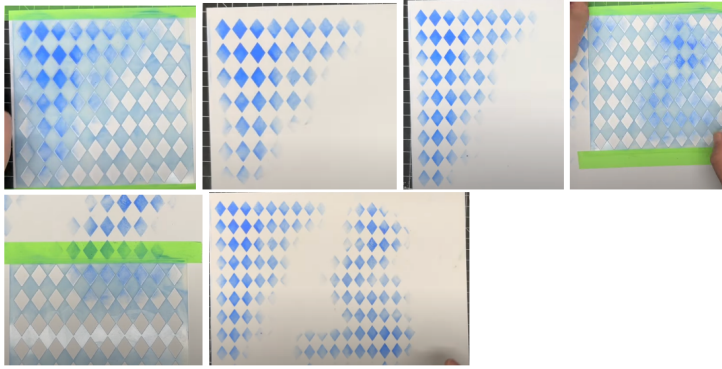

- We are then going to repeat this process using the smaller diamond stencil and the Verdant Fusion ink, again matching up the pattern each time.

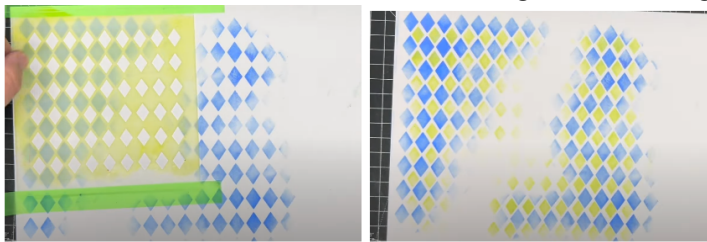

- Then take the outside 7" frame maker die from the Folk Art die set and position this over the design, tape it down and run this through your die cutting machine. You also get the middle cut out square which you could emboss or use for another project.
- Then using the outside 7¼" frame from the Delicate frame die set cut that out of the Essential Pacific Blue card.
- Add wet glue to the back of the patterned frame and add this onto the Pacific Blue frame. Add 2mm foam tape around the inside edge of the blue frame, remove the yellow backing, add a few dabs of wet glue to stop the static.

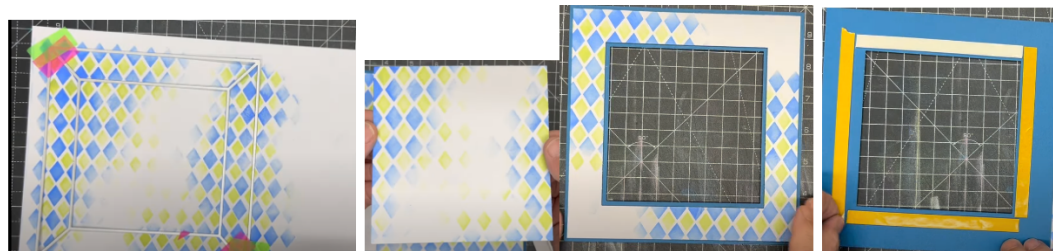

- Then with the embossed square face up onto your table top, hover over the design until you can match up the pattern and colours and add the frame onto the top.



- Take your 8" x 8" top folding card blank, add a 7⅞" x 7⅞" layer of Pacific Blue and a White layer which is 7¾" x 7¾". Add wet glue onto the back of your framed design and add this evenly onto your card.

- John has also made a card using the Sunlight and Pacific Fusion inks, this time adding a stamped flag sentiment across the middle of the card and decorate around the edge of the flag and bottom left-hand corner with a set of the Bubble Flower dies. You will notice that the inside of the flowers have been coloured with the same fusion inks, this is done by leaving the die cuts still in the die and go over the outside of the die with the inks, then when you remove the die you have the beautiful coloured pattern on the front. Then a corresponding dew drop colour has been added to the middle to finish off the design.

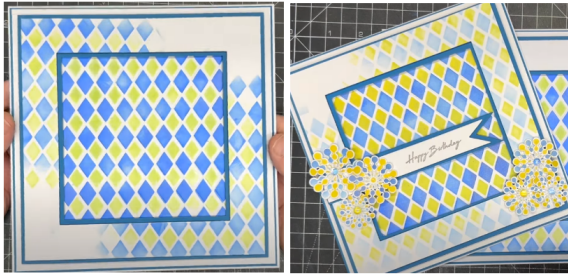

Your creation is now complete. I hope you have enjoyed these instructions.