

6" x 6" Envelope & Card - by John Lockwood



Instructions compiled by June Smith.

John has created a 'You Tube' video using the new 2 in 1 Scoreboard & Self-Healing mat to make a 6 x 6 envelope and card, dated 4th August 2024, I have incorporated these in this set of Instructions. I would advise that you visit them as well as following these instructions through to the end before commencing the project.

Information:

The Triangle guide is in millimetres, we want centimetres, so you ignore the end zero. Therefore, if we want 15cm, we score down at the 150mm mark, this is the same for all the measurements on the triangle.

Materials:

CT9026 2 in 1 Scoreboard & Self-Healing Mat
A3 White or coloured Card
Crafts Too Corner Punch CT9023
Craft Kit

Method:

- In the previous video we made a 5" x 7" card blank and also a 6" x 6" one from an A3 piece of white card. We will be using the 6" x 6" for these instructions.
- Using the Scoreboard self-healing mat and rule, which clips onto the top. Place your card just underneath the top silver measurements, it measures 15cm, so write this on a spare piece of card. Add 2 onto this which gives you the score line, which is 17 and we always add 10 (this is on any measurement of envelope you want to make irrespective of the size). Total is therefore 27cm x 27cm. We don't need the rule along the top for this next bit, so put this to one side.
- John has already cut his pink card to size. Bring in the corner measurement guide and clip this onto the top left-hand corner, as long as the left-hand edge is straight you can move this up as far as is necessary.
- Place the bone folder scorer on the 17 mark and score down. Rotate the card and repeat on all 4 sides.

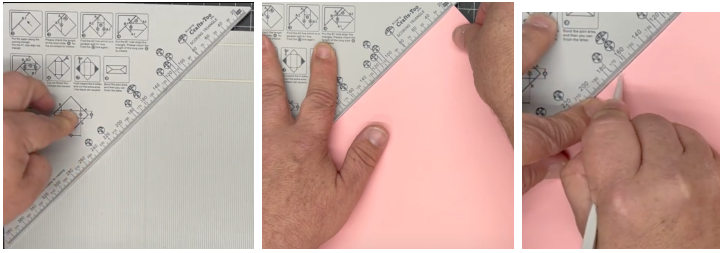

- Using your bone folder reinforce the folds. Take your scissors and cut the 4 triangles out.

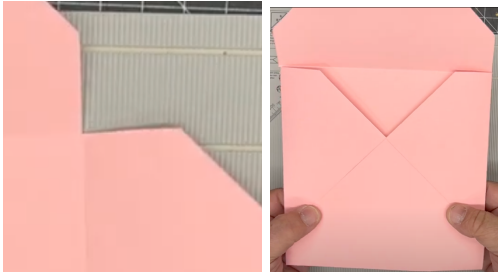

- Then using a corner punch, John is using the Crafts Too one which is perfect for this, so feed the card point into the punch and press down, this gives a nice round edge on the points.

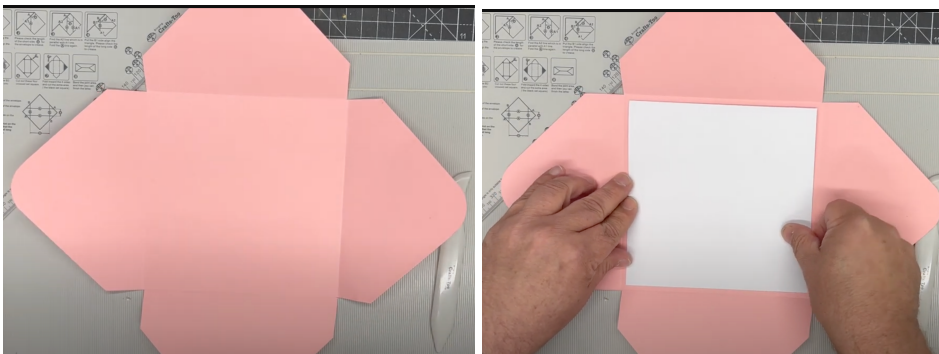

- Fold both side piece over first, then on the bottom flap add CA Super Tacky Glue onto the left side and up to about half way, repeat on the other side and fold this bottom flap upwards over the 2 sides and give it a good press down to make sure it is secure. Take your card and place this inside.

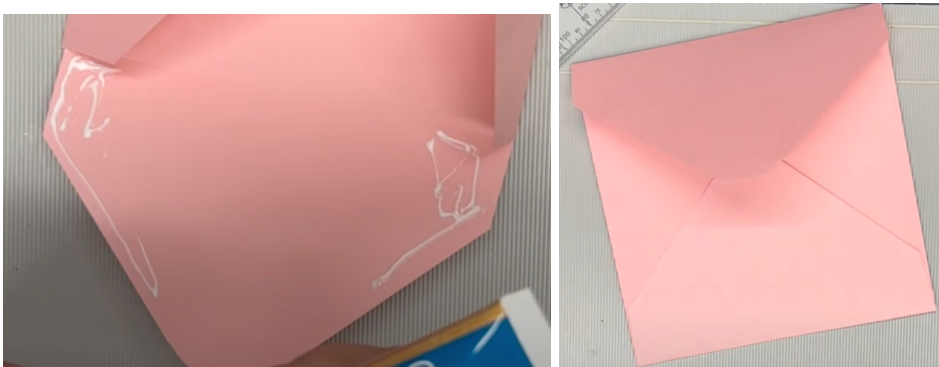

Your card and envelope are then complete. The scoreboard will allow you to make any size card and envelope you wish. Your 12" x 12" square pattern papers make a gorgeous envelope for your cards.