

JND457 Star Baubles – 10 July 2024 - by John Lockwood



Instructions compiled by June Smith.

John has created a 'You Tube' video using JND457 – Star Baubles, dated 10th July 2024, These have been designed to make separate Baubles or Snowflakes. I have incorporated these in this set of Instructions. I would advise that you visit them as well as following these instructions through to the end before commencing the project.

Information:



Dies 1 & 2 – The two largest Snowflakes which cut into the card

Die 3 – An outer cutting star die with loop on the top designed to work with die 4

Die 4 – Decorative snowflake which cuts into the card

Dies 5 & 6 - These are smaller embossed versions of dies 1 & 2

Die 7 – Smallest embossed Snowflake

Die 8 – Outer cutting die to fit die 7

Materials:

6" x 8" Whit Top Folding Card Blank (cut down from an 8" x 8")

JND457 Star Baubles Die set (8)

JND455 - 5" x 7" Frame It Die Set (15)

JND475 - Frame It 7" x 5" Die Set (9)

Essential Coconut White Card

CA Gold Waterfall Glitter Card

JND Snowflake Embossing Folder (due out soon)

CA Glue Glaze

3mm Cream Ribbon

6mm Blue Powertape

A4 Die Cutting Machine

Craft Kit

Method:

- Using Gold Waterfall Glitter card cut out the 1" frame from the JND455 5" x 7" Frame it die set.
- Using Coconut White card cut out the ½" frame from the JND475 Frame it 7" x 5" die set. Add foam tape onto the back and adhere onto the Gold Waterfall Glitter frame.

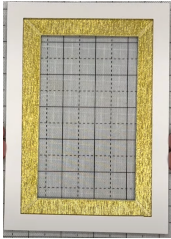

- From a piece of Coconut White card add the 2 largest dies tape them down, then using John's tape trick – take a long piece of tape pick up the centre die, hover over the outside cutting die until it is in the correct position all the way around and press down, you then have the 2 handles so you can pick both dies up and add onto the white card, then run these through your die cutting machine. You will get one that has the hanger on it and 2 that don't.
- Then bring in the left-over piece of Gold Waterfall Glitter card, and tape down the outside cutting die and cut that out 3 times. Adhere these together by using spray glue or glue glaze. It is not advisable to use normal PVA wet glue as you are trying to stick onto a waterfall glittered surface, and it is very difficult to get it to stick down.

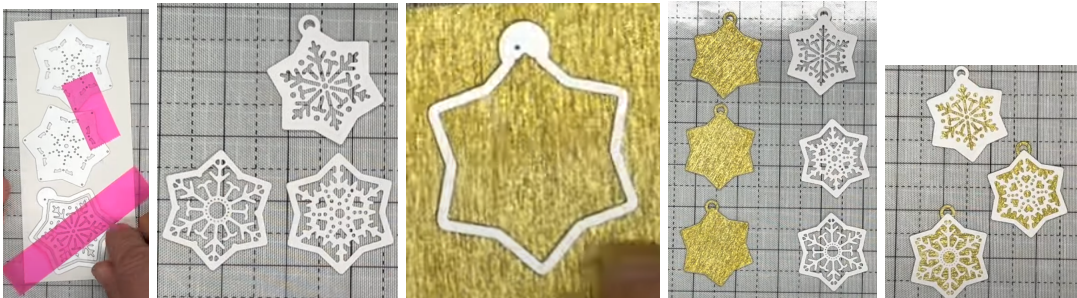

- Take a piece of ribbon and thread through your bauble and fold over, repeat on the other two. Now we want to attach these onto the back of your frame set. Turn your frame face down onto your table and use the grid lines or a template sheet to get it even, remove the covering from the top piece of foam.
- Then take one of the baubles and pull the ribbon so they are folded over absolutely evenly and add the top of the ribbon over the foam tape. Then repeat with the 2nd one, then for the 3rd one we need to add that so that the bauble is behind the first one. Using a pair of scissors snip off the top excess ribbon up to the edge of the foam.
- At this point we will make up our card blank, so take an 8" x 8" top folding card blank and cut it down to 6" x 8". Add a mat and layer of Waterfall Gold Glitter card layer cut to 7¾" x 5¾", and Coconut White to 7⅝" x 5⅝".
- We then need to take a Snowflake Embossing Folder and emboss a piece of Coconut White Card; the one John has used will be coming out very soon.

Add this face down onto the back of the frame, turn it over and take your scissors at an angle and cut off the excess.

- Add wet glue onto the back and adhere this onto the card blank.



- Turn this over and fold 2 of the baubles up over the frame, we don't really want the baubles to be swinging, so take a little piece of 2mm foam tape and add it to the back of the snowflake bauble, repeat for the 2nd one, but for the final middle one we want this to stand proud so take a slightly longer bit of foam tape and fold it over, then remove the yellow backing and add onto the back of the long one. At this point you could add a sentiment of your choice, John has left his off until he needs to add it when going to send it.



Your card is now complete, I hope you have enjoyed these instructions.