

## CCL Sam's Holly – 28 August 2024 - by John Lockwood



Instructions by June Smith

John has created a 'You Tube Video' dated 28<sup>th</sup> August 2024, using JND477 Sam's Holly Frame Die set, as well as some of the Dies launching on Sunday as they were designed to work together. I would advise that you visit it as well as following these instructions. There are some beautiful samples at the end of these instructions.



### Information:



There are 8 dies in the set as follows:

- 1 Outer frame
- 2 Inside square dotted frame
- 3 Smaller version of the main outer frame
- 4 Inner circle and holly die
- 5-6 left and right holly sprig
- 7-8 smaller left and right holly sprig

### Materials

- 7" x 7" White Top Folding Card Blank
- 5" x 5" White Top Folding Card Blank
- JND477 Sam's Holly Frame (8)
- JND459 Holly Sprigs (4)
- JND461 Star Sprays (4)
- JND480 Ice Flowers
- JND452 Infinity Embossing Folder

CA Spring Green Satin Card  
 Essential Coconut White Card  
 A4 Die Cutting Machine  
 CA White stick on Pearls  
 Glue Glaze  
 Spray Glue  
 2mm Foam Tape  
 Craft Kit

**Method:**

- Take a sheet of Spring Green Satin Card and using the new Trimmer cut off the excess card. It is always advisable when cutting out dies that you trim off the excess before running through your die cutting machine, because it will cut better. Use your pokey tool to push out any of the excess pieces. Then John brought in a beautiful Spring Green Mirror and Coconut White frame which were made from the new 5" and 6" Frame It dies coming out this Sunday. Look how lovely this looks when you place this over the frame which fits exactly. John then adds spray glue onto the back of the frame and adds onto the new frame.



- Then when you put this onto a card blank that John has prepared you can begin to see how stunning this looks.
- Cut a piece of Coconut White card and embossed it with the Infinity Embossing Folder, then add foam tape onto the back of the frame, removed the yellow backing and add the embossed piece face down onto it.
- John has already prepared a 7" x 7" White top folding card blank, with a mat of 6<sup>5</sup>/<sub>8</sub>" x 6<sup>5</sup>/<sub>8</sub>" Satin Green card and another of 6<sup>1</sup>/<sub>2</sub>" x 6<sup>1</sup>/<sub>2</sub>" Coconut White. He has then added wet glue onto the back of the card and adhered onto the card blank.

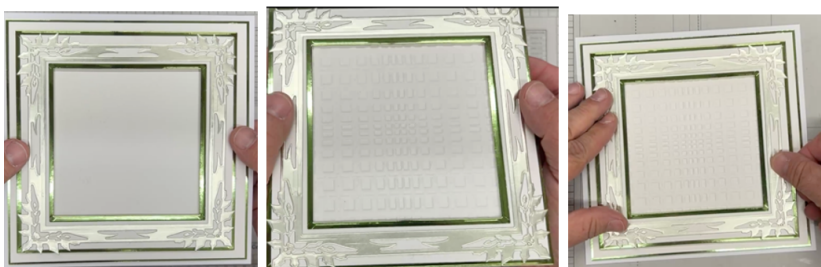

- Then take the waste Satin Green square piece left over from cutting out the frame and cut this piece out of die no 3, which is the inner square with a solid circle in the middle. You get the outside square with the stitched edge to it and also the die cut with the solid circle in the middle with the delicate corners on it. We want to use that outside square, so place it into your guillotine and measure the width of it, you will find it is 4<sup>3</sup>/<sub>8</sub>" x 4<sup>3</sup>/<sub>8</sub>". Cut a piece of the Spring Green Mirror card to 4<sup>1</sup>/<sub>4</sub>" x 4<sup>1</sup>/<sub>4</sub>" square. Spray glue the back of the Spring

Green piece and add onto the Spring Green Mirror card. Then position the cut piece back into it, it looks so expensive, but John will show us a trick with it later.

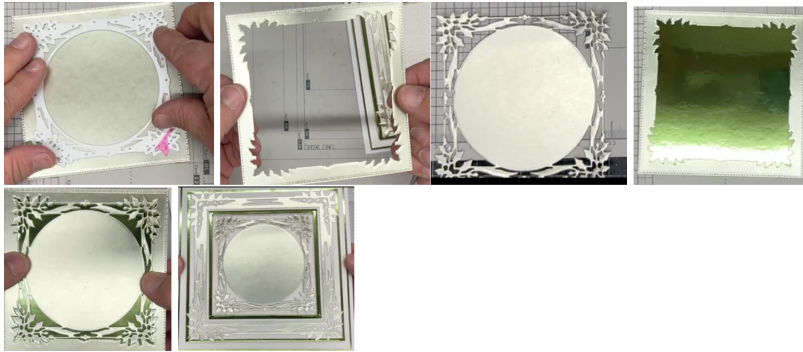

- Take the original centre you cut out and add 3 strips of foam tape onto the back, then adhere this into the square card. It does cover a lot of the embossing but trust John as this is a real mental piece pleaser.
- Take the other waste piece of Green Mirror card and tape down the 4 Holly Sprig dies and cut them out.



- We are then going to soften the colour by using the JND461 Star Sprays to cut out from Coconut White card. If you have trouble getting small die cuts out of a die, place the card face down onto your moulding mat then take your ball tool and just press down on the die cut areas, this way you mould the sprays/flowers/sentiments etc. at the same time as releasing them from the die – great tip John.
- Place the white sprays into position on the front of your card and you can see how it softens the green, we are not sticking these down yet.
- We are now going to bring back the scrap of Satin Green and cut out the Ice Flower plate, the flowers on here really are amazing. Take the petals and pinch each of the petals downwards, lay them onto your table in size order. For this card we are not going to use some of the little centre stars. Take your stick on White Pearls and a pair of tweezers, if you wanted too you could add a small dab of glue glaze into the centre and then add the pearl, or just stick one into each of the petals. Then place the 2 largest centres into the palm of your hand and use a ball tool or tweezers to press in the middle to shape them, then pop a pearl into the middle of those.



- You can do the arranging of your Foliage, Sprays & Ice Flowers onto the front of the card anyway you wish, there is no right or wrong way, this is the way John does his. Use Glue Glaze onto the back of 3 of each of the foliage and sprays and arrange on the front of your card. Then use wet glue onto the back of the Ice Flowers and arrange these onto the card. Then finally add the remaining foliage and sprays onto the card.



- When you move the card around you can see the depth of flowers on the card, please watch the 'you tube' and see John moving it around.

We have not finished yet because we have the waste pieces, so let's do something with them.

- If you have not poked all the bits out of the die cut, then do this now, then you can add wet glue to the back of the circle on the Satin Green die cut and drop this back into the front of the card, you will notice that we have not glued the 4 corners, so they are standing up a bit.

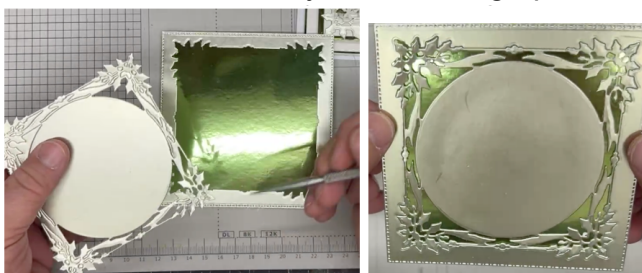

- Bring in your 5" x 5" white top folding card blank. Add foam tape onto the back of the card and adhere onto the card blank.
- John then has some of the foiled Holly leaves left over from another project, if you recall, you add the die to your card and then add foil over the top and run that through your die cutting machine, when you then remove the foil you will notice that the veins on the Holly are green and the rest of them are white. Use Glue Glaze on the back of the Holly and adhere onto the bottom left corner of your card. Then using wet glue onto the back of a 3 of the flowers and arrange these in a cluster onto the Holly Leaves.





- You can then see that we have made 2 beautiful cards, the second one using the waste from the first and some left over Holly from another project.



Your creations are now complete. I hope you have enjoyed these instructions.

John now shows us the boards contain the die cuts from the new dies which are launching on Create & Craft on Sunday 1<sup>st</sup> at 6pm & 9pm, then Monday 2<sup>nd</sup> at 10am and 2pm. They are as follows:-

Frame 1:

JND487 6" x 6" Frame It - Deco Frame Maker (10) – this is a 1" wide frame with a 4" aperture in the middle. You can ribbon thread through this one and also paper piecing. You get lots of small circles as waste as well, these will be very useful.

Frame 2:

JND488 5<sup>3</sup>/<sub>4</sub>" x 5<sup>3</sup>/<sub>4</sub>" Frame It – Celtic Frame Maker (8)

This is the 5<sup>3</sup>/<sub>4</sub>" Celtic Frame with an aperture of 4<sup>1</sup>/<sub>4</sub>" in the middle.

Frame 3:

This frame is just the 2 solid frames layered onto each other – this is also what John has used to make the card earlier.

Frame 4:

This is if you use a 5" frame behind, you actually get another layer, so 3 layers in total

Frame 5:

This is the scrap or waste from the middle of the 3 new frames.

Frame 6:

This is the 6" White frame, then the 5¾ Red frame and finally the 5" Black frame and the decorative panels cut together to give this stunning decorative frame.  
JND489 5" x 5" Frame It – Georgian Frame Maker (16)

So again, lots of different looks before we start changing colours or inserts, the permutation of 'Frame It' die sets that John has produced really are genius, with all the matching decorative inserts.

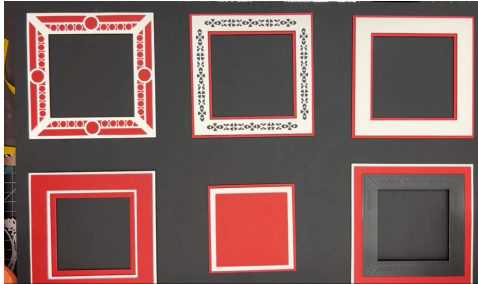

This is the 5" frame board with all the various single and combination die cuts.

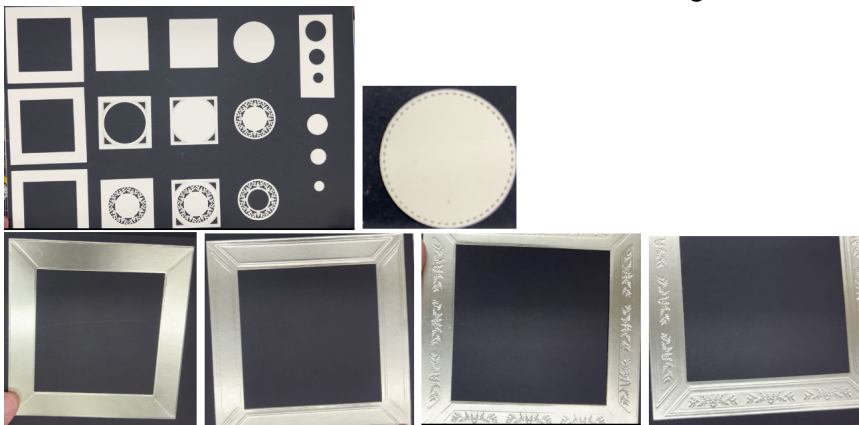

This is the 5¾" x 5¾" Celtic Frame board, again with various single and combination die cuts. If you remember the single Infinity die, everyone said they wanted a bigger background die using it, so this has 4 of the infinity within the square which can be cut out of a whole sheet of card.

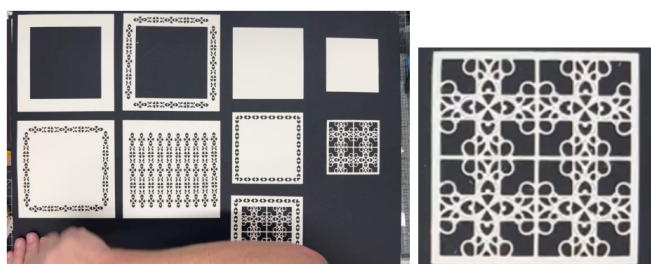

This is the 6" x 6" Frame It - Deco Frame Maker, again with all the permutations you can use, and I am sure you will come up with more once you start playing.

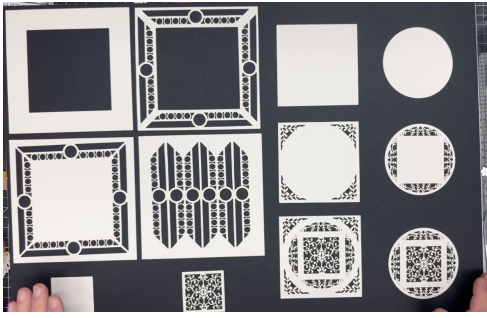

John is now showing some of the samples for the shows.

