

JND 488 – 5.75 x 5.75 Frame It – Celtic Frame Maker - by John Lockwood



Instructions compiled by June Smith.

John has created a 'You Tube' video using the above mentioned dies, dated 27 August 2024, I have incorporated these in this set of Instructions. I would advise that you visit them as well as following these instructions through to the end before commencing the project.

Information:

There are 8 dies in the set and I have listed them below in number order from the largest to the smallest as it is easier to refer to the number when cutting out the dies. The 4 Celtic dies which fit into the frame will also work with some of the other dies in the collection including some of the Christmas collection. There will be other dies coming out throughout the rest of this year and next year that will go into here as well so you will get lots of different looks.

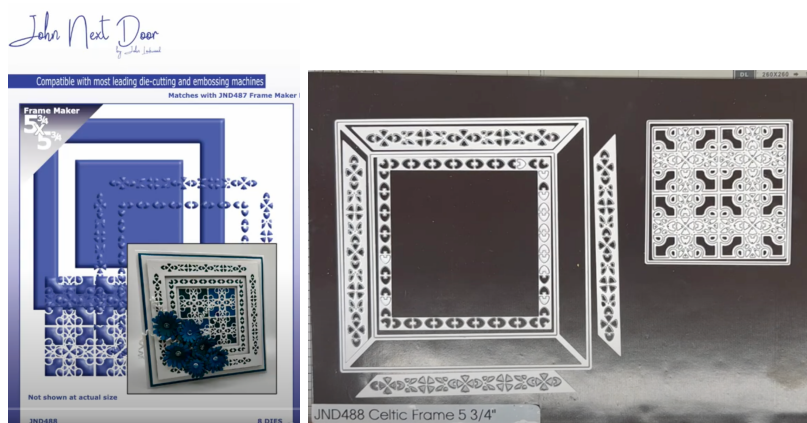

- 1: – 5³/₄” x 5³/₄” Main Frame It die.
- 2: – 5: - These are the 4 Celtic patterned cutting dies which are slightly smaller and will fit inside the Main Frame, these highlight the mitred corners
- 6: - This is a smaller Celtic frame without any outside or inside cutting edges.
- 7: - Square die which fits inside the small Celtic Frame no 6.
- 8 : - Square Celtic Panel, (this matches the Infinity die set)

This frame will also work with the 6" Deco Frame, there is a separate video and set of instructions which show how to incorporate all these dies together.

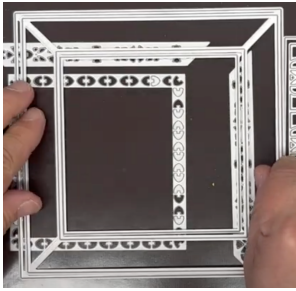

Today we are going to make a smaller version of this 7" x 7" card where we change the size slightly and not adding the flowers which will be released very soon. When cutting out your dies always secure them with reposition tape, so the dies do not move.



Materials:

- 6" x 6" Top Folding White Card Blank
- CA Essential Coconut White Card
- CA Teal Card
- CA Aegean Blue Card
- JND488 5 $\frac{3}{4}$ " x 5 $\frac{3}{4}$ " Frame It – Celtic Frame Maker (8)
- JND Stamp Set
- Teal Ink Pad
- 2mm Foam Tape
- Die Cutting Machine
- Craft Kit

Method:

- Take an A4 sheet of Coconut White card and add die no. 1 the outside frame and dies 2-5 which are the Celtic panels. Then take a piece of the Teal card and cut out just die no 1 on its own. The beauty of these frames are that you don't have to mark which is the top or bottom, because each side is exactly symmetrical. Glue them together using wet glue.

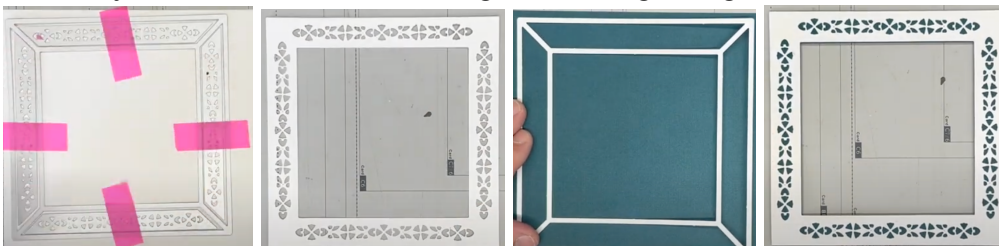

- Cut another piece of Coconut White card to 5½” x 5½” which is just slightly smaller than the frame. Add the square die no 6 with a Celtic pattern on it and run this through your die cutting machine. We want to cut the centre out of this so here is a little trick – cut a piece of the Aegean Blue card to 5½” x 5½” and using spray glue or wet glue, stick these together. Then add die no 7 which is a square die that fits inside die no 6 and cut them out. This will then give you the square with the middle square cut out from both of the layers. Add foam tape onto the back.

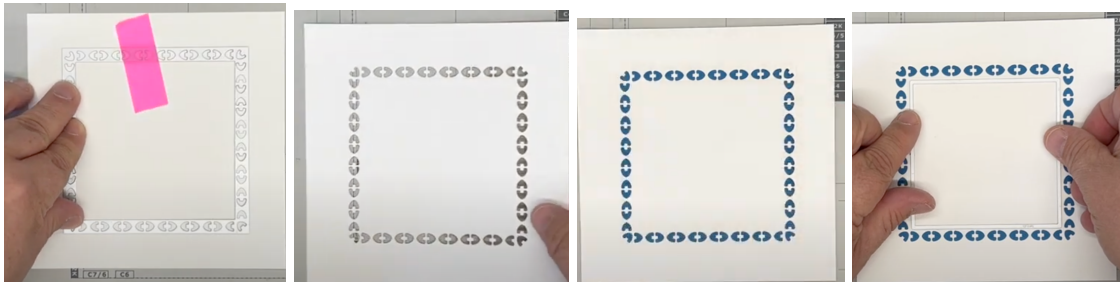

- Bring in your main frame, add foam tape on the back, remove the backing and adhere onto the background piece – you can see the lovely patterns with the 2 different colours. If you get any areas behind that are popping out use the new free-style trimmer to cut them off, it is so much easier than using a guillotine or ruler and scalpel – or you could use a large pair of scissors at an angle to undercut the excess off.

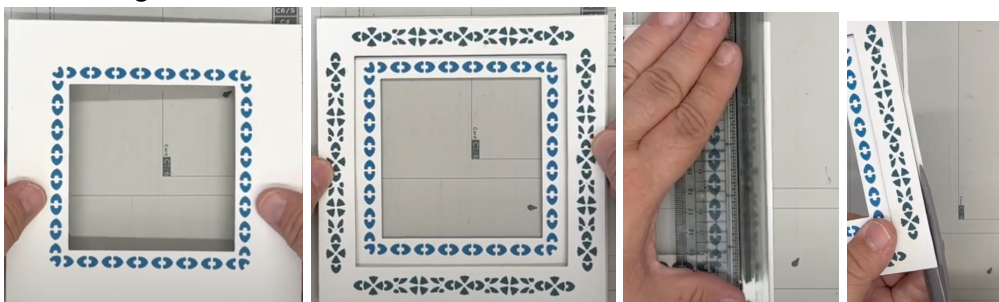

- Now we want to cut the Centre panel no 8, this is a die request because one of the squares is what we used in the Infinity die and John had loads of requests to not have a repeating pattern of it, which of course John agreed to, he has rescaled it to put the 4 panels together as one die. He then cuts this out of a 5½” x 5½” piece of Coconut White card. The die has been designed so that you can continue to gut the pattern out from the left, right, top or bottom to make another card.

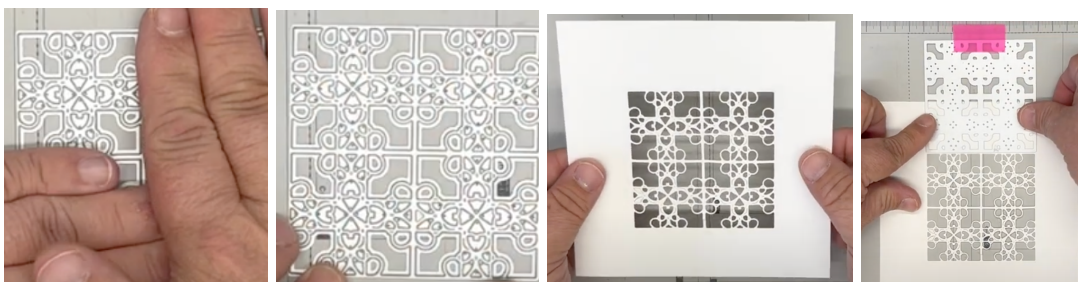

- We want a background for this so using the Teal & Aegean blues, cut the Teal blue to 5½” x 5½” and 2 pieces of the Aegean Blue to 2¾” x 2¾”. All you need to do is to glue them on the top left and bottom right corners making

sure that they match in the middle and you can add your white panel onto the top.

- Bring back in your frame piece that you have made, remove the yellow backing from the foam tape and adhere this onto the square. Again, if you have any of the background card showing just take your scissors at an angle and trim it off.

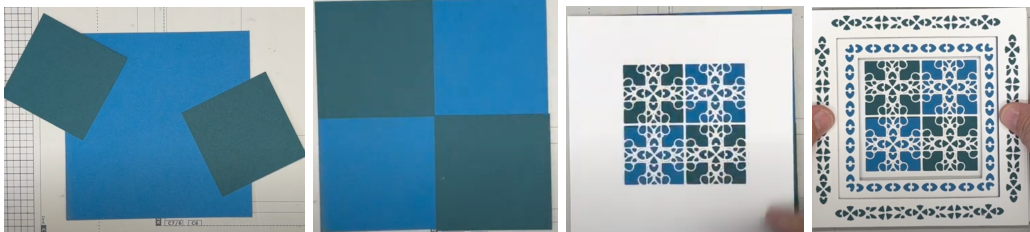

- Bring in your 6" x 6" top folding card blank and adding wet glue onto the back of your main panel and add onto the card blank.
- To finish John has stamped a little sentiment with a matching ink pad colour - 'Is it just me or have you had a lot of Birthdays' onto a scrape of Coconut White card, then layering this up onto a piece of Teal card.



- Then cut one of the Shadow Leaves dies in the same Teal card, add wet glue onto the back and added this onto the front of the card.



Your card is now complete, I hope you have enjoyed these Instructions.