

## JND489 – 5 x 5 Frame It – Georgian Frame Maker - by John Lockwood



Instructions compiled by June Smith.

John has created a 'You Tube' video using the above mentioned die set, dated 27 August 2024, I have incorporated these in this set of Instructions. I would advise that you visit them as well as following these instructions through to the end before commencing the project.

### Information:

There are 16 dies in the set and I have listed them below in number order from the largest to the smallest as it is easier to refer to the number when cutting out the dies

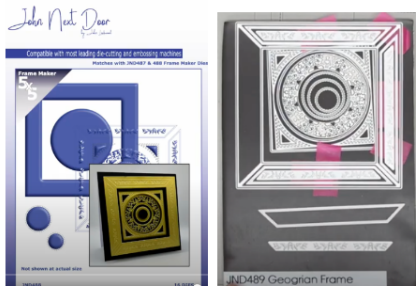

- 1: – 5” x 5” Main Frame It die, with a 3½” square in the middle of the frame, this gives a ¾” frame all the way around.
- 2: – 5: - These are the 4 debossed cutting dies which are slightly smaller and will fit inside the Main Frame, these highlight the mitred corners
- 6: – 9: - These are the 4 Georgian debossed pattern dies (they don't cut in or out ) that fit inside dies 2 – 5.
- 10: - Square die which fits inside the Main Frame It Die
- 11: - Square double stitched cutting die with double stitched corners on it
- 12: - Inside Plain Circle
- 13: - Decorative Filigree Circle Frame
- 14: - 16: are decreasing in size double stitched circle dies.

### Materials:

- 6” x 6” White Top Folding Card Blank
- JND489 – 5” x 5” Frame It – Georgian Frame Maker (16)

CA Gold Satin Card  
 CA Gold Mirror Card  
 CA Black Card  
 Die Cutting Machine  
 2mm Foam Tape  
 Removable tape  
 Craft Kit

**Method:**

- John has already prepared this first piece with some of the dies in position, he will then show how to pick up the 2 remaining dies and add them into the frame using removable tape. Cut a piece of the Gold Satin Card to 5½” x 5½”, then bring in dies 1-9. Place dies 2 & 6 onto your board as even as you can, then take a piece of removable tape and tape them together, then add them into one side of the frame, repeat this for all 4 sides. **Tip** If you want to cut more than one frame all you need to do is to add more removeable tape into the 4 corners and cut out as many as you want. The frame when cut should look as below.

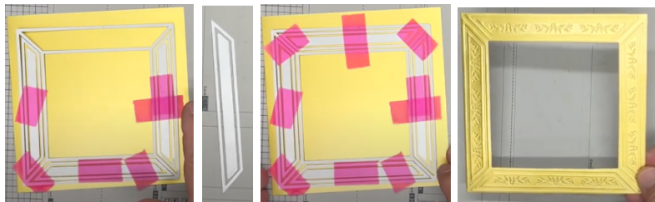

- You can also use this frame, the JND487 6” x 6” Deco Frame and the JND488 Celtic Frame cut out of Black and White card to make this beautiful card below.



- Cut a piece of black card to 4½” x 4½”, take the next die down which is the plain square (no 10) and cut that out of the centre. Then add 2mm foam tape onto the back of the Satin Gold frame, remove the yellow backing and add this onto the Black frame, add foam tape onto the back and put to one side.
- Then take a piece of Gold Mirror card and a long piece of removable tape and add die no 11, which is the inside plain circle, tape them down cut this to give you this double line of stitched corners and circle. If you cut 3 of these in a line they would go perfectly onto a DL card front.

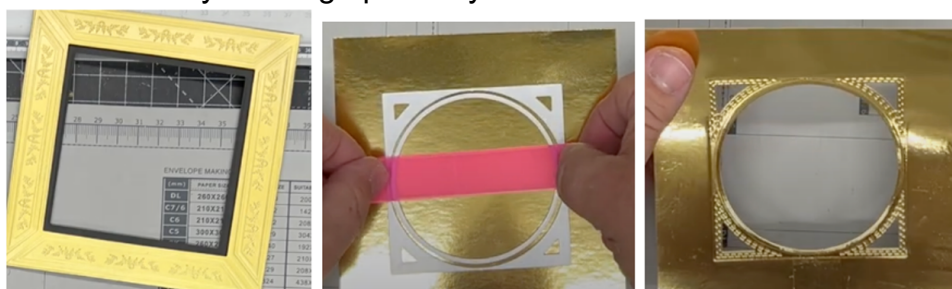

- Cut another 5" x 5" piece of Black card, add this behind your gold mirror piece, then take the circle die No 12 again, tape it down and cut it out. This gives you the perfect square with a circle in the middle and the black showing in the corners. Then bring back in your Gold and Black frame, remove the yellow backing and add this over the Gold Mirror/Black corner piece.
- Take the centre Satin Gold square left over from when you cut the main frame and cut out die 13 which is the Decorative Filigree circle and cut this out of the middle.
- Turn the main frame set over and add 2mm foam tape around the circle and a couple smaller pieces in the 4 corners around the circle.



- Turn that over and add foam tape around the outside of the filigree circle and a small piece in the centre and cover this up with another 5" x 5" square of the Black card to cover it all up and neaten it.
- From the left over offcuts use die 14 to cut out from Gold Mirror, die 15 from Black and die 16 from Gold Satin Card. Adhere these circle all together to give you what looks like a little target, add a small piece of foam on the back and adhere into the centre of your card.



- Finally add foam tape onto the back and adhere onto your top folding white card blank. John has also made one layered onto a Black top folding card blank which also looks very elegant. You could add flowers onto the card. I prefer them without as they are absolutely gorgeous as they are showing all their glory, a real Harrods card.



Your card is now complete, I hope you have enjoyed these instructions.