

## JND472 - Lantern Village Scenes - 3 November 2024 - by John Lockwood



Instructions by June Smith

These instructions are taken from John's You Tube video dated 4th November 2024, where you will be able to make a beautiful card using the Lantern Village Scenes die set. I would advise that you visit it as well as following these instructions.



JND472 Lantern Village Scenes, as you can see from the photo above the first 4 dies have been designed to give a hillside. As usual I am going to give all the dies a number so that they can be referred to within the instructions.

- 1) A window outside cutting die with a left-hand hill with small deer on it
- 2) A window outside cutting die with the Church and house on it
- 3) Shorter window with outside cutting die with a house and tree on it
- 4) A window outside cutting die with the right-hand large house on it
- 5) A Stitched Window
- 6) A Plain Cutting Window
- 7) House similar to inside of die no. 4, but with different shaped hills
- 8) Tallest houses sitting on a different shaped hill
- 9) A Deer and young Dow on wavy hill

- 10) A Deer with different trees on both sides of the hill
- 11) A Deer with different trees on both sides of a different hill

### Materials

6" x 6" White Card Blank  
 JND472 – Lantern Village Scenes (11)  
 JND508 Handy Sentiments Stamps  
 Essential Coconut White Card  
 CA Canvas Card - Neutrals  
 Precision Press Stamp Block  
 VersaFine Smokey Grey Ink Pad  
 Die Cutting Machine  
 Craft Kit

### Method:

- Cut a piece of Coconut White card to 5" x 5" and take die no 5 which has a beautiful stitch design around the outside, and using the new Multipurpose Craft Mat to lay the die 1" down from the top, 1" in from the side and 1" up from the bottom. These are all solid black lines. Tape the die down and run through your die cutting machine.
- Then remove the die and bring in your Precision Press Stamp Block. Lay the 'Happy Christmas' stamp onto a black line, then place the stamping block over it and press down to pick the stamp up, turn it over and ink the stamp with Smokey Ink pad, then bring back in your 5" card front and position this so that you can see the solid black line at the bottom of the aperture, then press down onto the block, when you lift the block up you will see that it has stamp up perfectly.
- We will be using all of the 4 shades of canvas card from the Neutrals pack, so take the lightest colour and cut it to 4¾" x 4¾", place this on the line of your mat and bring in die no 1 and place that in the same position as you did for the white card, tape it down and run that through your die cutting machine.
- Then repeat this using the Soft Grey colour cut to 4¾" x 4¾" and for this one we will use the house die no 4. Repeat again using the Slate Grey colour and die no 2 which has the Church on it. Then cut a piece of the Grey card cut to the same size.

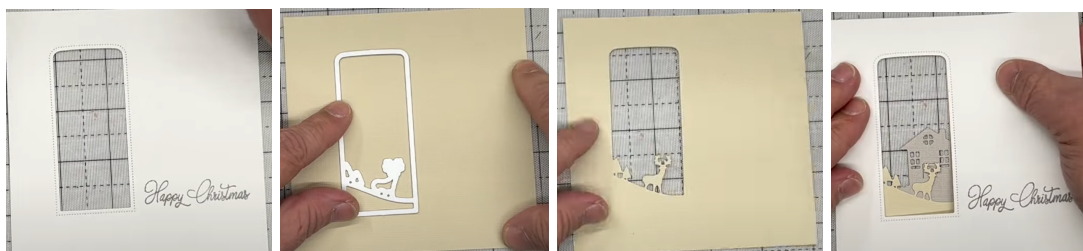

- Place the darker Grey onto your mat and turn the Slate Grey piece over and add wet glue around the outside and also around the aperture, and a couple of dots onto the Church and House. Repeat with the Soft Gray with the large house on it, turn this over adding wet glue onto the outside of the back and around the aperture, and a 3 little dots under the top window of the house, and layer that on the top. Repeat again with the lightest colour square with the deer and little tree scene, and the wet glue onto the back and adhere over the front of the card, don't worry if the outer card is protruding out we can cut

this off, but just make sure that none of the previous colour in the layers is showing through. Finally finishing off with the top white piece again adding wet glue around the back and the aperture and on the deer and layer that up.



- As you can see there is a little bit of the grey popping through, so take your guillotine, put the card back onto the 5" measure and cut the little slither of grey off, you can do this on all 4 sides if there is any overhang.
- Then bring in your 6" x 6" card blank, layer this up with the dark grey and a coconut white on the top. Add wet glue to the back of the main piece and add onto the layers.



Your card is now complete, I hope you have enjoyed these instructions.