

JND496 Zora Flowers & JND510 Vine Leaves - by John Lockwood



Instructions by June Smith

John has created a 'You Tube Video' dated 23 January 2025, using the new JND496 Zora Flowers & JND510 Vine Leaves die sets, where he demonstrates how to make a card. I would advise that you visit it as well as following these instructions.

Information:

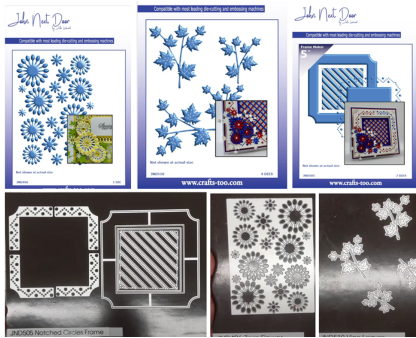

Die 1 – Main FrameMaker ($\frac{3}{4}$ " wide square inner frame which is x 5" wide, it has a notch in all 4 corners of the outside of the frame.)

Die 2 - 5 - Notched Patterned panels to fit inside the main frame.

Die 6 – $3\frac{1}{4}$ " Square die

Die 7 – 3" Inner Diagonal Stripe die

JND489 – Georgian Frame

More information coming soon, we are just using the outer frame for this project.

Die 1 – 5" x 5" Frame Maker die

Materials

7" x 7" White Top Folding Card Blank

JND496 Zora Flowers Die (A6)

JND510 Vine Leaves (4)

Essential Coconut White Card

CA Warm Tones Canvas Card – Various Deep Red Colours

CA Summer Greens Canvas Card – 2 different shades of Green

Or you could use Essential Moss & Olive Green card

CT Flower Moulding Foam & Ball Tool
 A5 Die Cutting Machine
 White Pearls various sizes
 Glue Glaze
 CA 3D Glue Gel
 Craft Kit

Method:

- John is holding 2 different types of Zora Flowers using 2 different reads from the CA Canvas Card Pack. You can get cut the die plate out 4 times from an A4 sheet, which will give you 80 flowers in total. It works easily on its own or on the card below with the matching Vine Leaves. We will be working with 3 different colours from the Canvas card.



- Using the Dark Red in your pack cut out a set of the Zora Flowers, then from the Pinky Red Warm Colour cut another set out and lay them onto your table in size and colour order. Then add a dab of Glue Glaze into the centre of all 4 sizes of both coloured die cuts. Then using your multi-purpose pick up tool, simply add the larger darker flower onto the lighter flower offsetting it so both colours show. Repeat for the next size. Then this time we are going to add the lighter red onto the darker red, offsetting them. Repeat this process so you end up with 8 flowers in total.

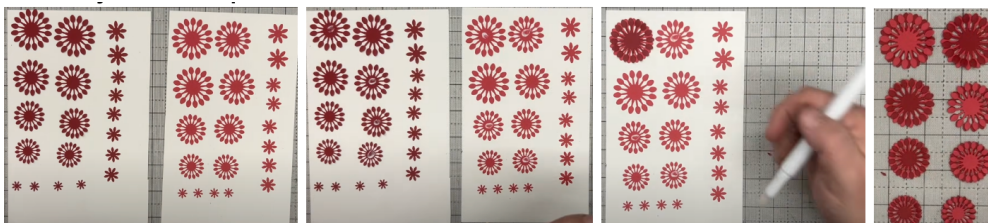

- We now want to shape these and add the centres. Bring in your Crafts Too Moulding Mat and matching ball tool. Then using your pick up tool again add the rest of the flowers onto to it in size and colour order. Then using the larger end of the ball tool just circle into the middle of all 14 ones, then turn the ball tool around to the smaller side and repeat the circle motion in the remaining 8.
- Then bring the larger flower and place onto the moulding mat, then press your ball tool into the middle and circle around just once so the sides pop up. John is just doing one of each size so you can see what the process is. Then add a dab of glue glaze into the centre of each flower and rotating the colour add the next size down flower onto the middle. Repeat this process for all the sizes, and you should have 2 tiny ones left, so add glue glaze into the centre and offset the other one on top. Hopefully you can see this in the photos below.

- Then add a dab of glue glaze into each of the flowers and using your tweezers pick up one of the CA White Stick-on Pearls (in size order) and add into the centre of each flower. You should then have all the flowers done.

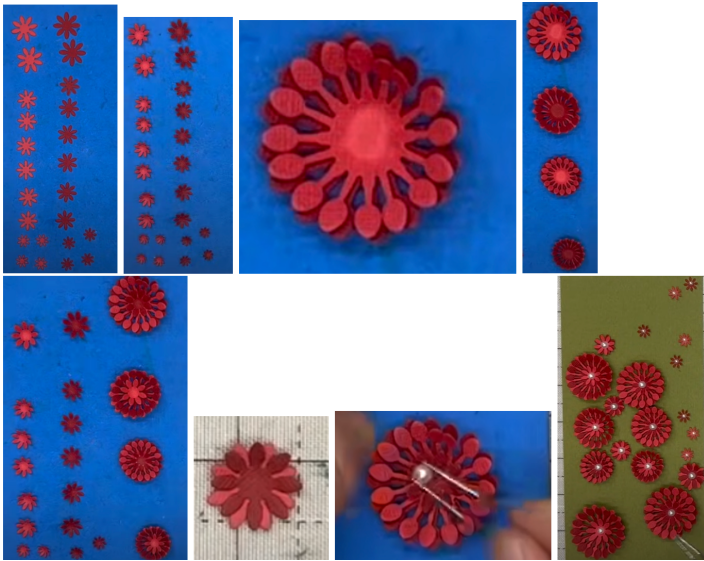

- Now we need to cut some of the Vine Leaves, you have a left and a right in the large and small dies.
- Bring in the card which was made in one of the previous videos (separate instructions are on the group for this). We can then decorate the front of it.
- In the bottom left corner build up the Vine Leaves using glue glaze on the back. Swapping colours and position as you go along. Don't use all the leaves as we want to add our flowers and then add more of the leaves, so it looks like the leaves are coming out from behind the flowers.
- When we adhere the flowers into position we will use a dab of the CA Glue Gel onto a cocktail stick, which allow you to use the stick as a sort of handle to position the flower into place. Then go back to using the glue glaze to add some of the smaller little tiny flowers around the trellis where you see a little gap.

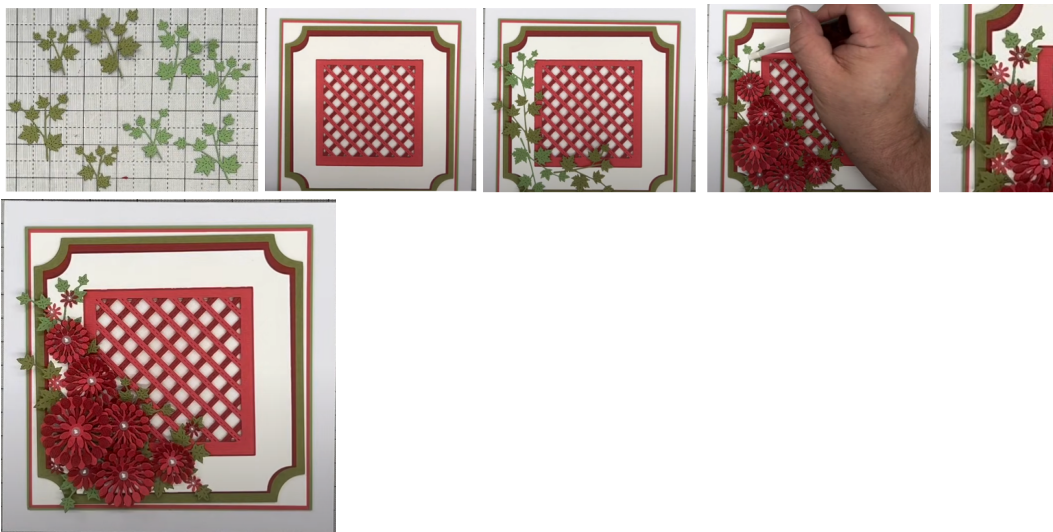

Your creation is now complete. I hope you have enjoyed these instructions.