

## CCL – Craft Artist Pastes – 5 February 2025 - by John Lockwood



Instructions compiled by June Smith.

John has created a 'You Tube' video using the New Craft Artist Pastes, dated 5th February 2025, I have incorporated these in this set of Instructions. I would advise that you visit them as well as following these instructions through to the end before commencing the project.

### **Information:**

Many of you will have noticed that Craft Cave Live was on Facebook as an Event, if you click interested, you will get a message an hour before that the event is happening. If you don't grasp the idea of putting comments in the live shopping, you can go straight to their website and buy it like you would normally. On Monday, and only on their exclusively, is the JND Box Kit, it is the only one we are doing this year, and it is all based on the smaller clock, here is a sneak peek of the papers and small clock, which Sam has made.



We have also been able to stream this live on 'John Next Door Official' also on Crafts Too and The Art of Craft. If you have any questions tonight, simply type the letter 'Q' and type in your question and either Sam or John will reply either at that moment or at the end of the Live. There is a date for John's workshops etc. which as at the Academy in Chesterfield, emails are due out today or tomorrow with all the information. Spaces are limited, so book as soon as you can, so if you are interested in any of them please click the link to book your place.

The Art of Craft will be at the Motorcycle Museum in Birmingham with the fantastic Lesley Lakin demonstrating on Saturday 8th or Sunday 9th.

We have only got notification today that we have managed to get a location in Farnborough/Frimley to do a workshop on Thursday the 27th of February, so the day

before Sandown. It's a live 'in person' workshop with John, Jane and possibly Penny, it is already available to book on the Art of Craft website, it is limited numbers so either book it on line or ring the shop, the address is 'The Miners Arms Pub', 2 Mytchett Road, GU16 6EZ, which isn't far from our normal venue. It is from 10am – 3pm, and the cost is £45.



One of the things John has been asked about is putting the paste on acetate and adding Lights behind, so this is one of the things we will cover today. If you look at the photo's below, one is showing on a clear acetate background, it looks like a Mother of Pearl finish but look what happens when you put it onto a black background, suddenly the colours pop.

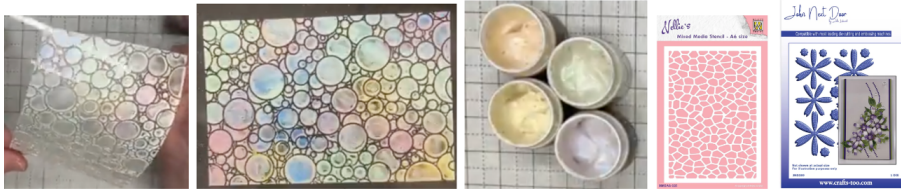

### Materials:

- White Top folding Card Blank
- JND505 – Notched Frame (7)
- JND389 – Stitch Flowers
- CA Fusion Starlight Pastes – Sapphire, Emerald, Gold and Ruby
- Nellies Stone Pavement Stencil MMSA6-025 (or any stencil you wish to use)
- Essential Coconut White Card
- Black Card
- Vellum
- Lights
- Craft Kit

### Method:

- Cut a piece of Acetate to 6" x 8" and place onto your Multi-media Mat and take a long strip of repositionable tape and add this all around the outside of the stencil. There is no need to use a spatula or similar, just use your finger (or a dauber) to pick up a little bit of the Sapphire paste and go lightly over the stencil in a circular motion in different areas, then repeat with some Emerald, Ruby, and finally some Gold over anywhere that you have missed or only got a light covering from another colour. Remove the tape and use your pokey tool to just lift the top of the stencil off and you can see how this now looks, it is so hard to capture the colours when I can only take a still photo, but if you

watch the FB Live you can see this for yourselves. There is another shot below with black card behind it.

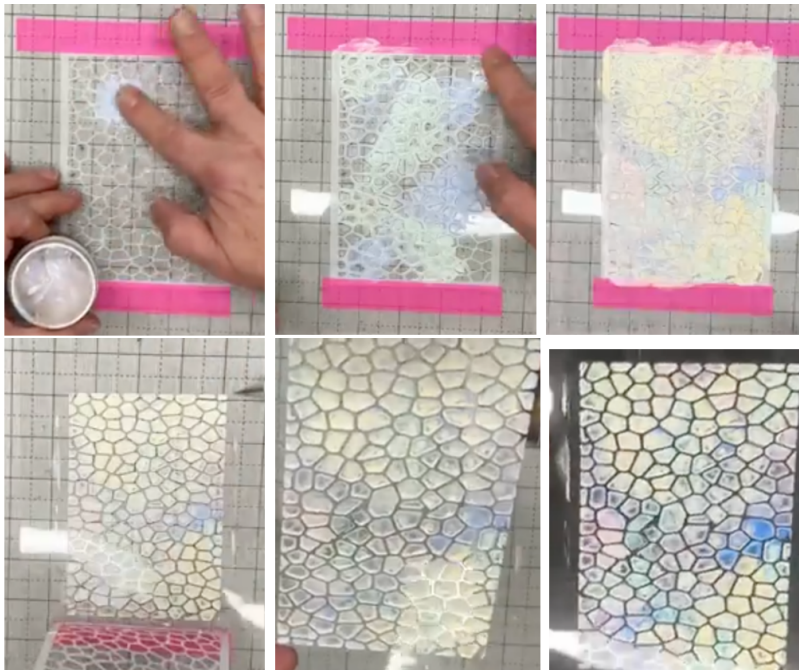

- John is then showing use another way using another piece of Acetate and adding the same stencil onto it, but this time using a Spatula. You can see that there is less control of the paste when using it, also putting a lot thicker coating on it, when really there is no need, but this is your choice. Just remember that when you add paste onto Acetate with your finger it takes a good 4 – 6 hours to dry, but if you use a spatula it takes a good 12 hours, John has made some the day before which he will use later. John has then used the spatula with the left over paste on it, to add onto white card and it dries very quickly, see how much it has spread over, and that is just using what was left on the Spatula, it looks just like Pearlised card. You can see when John holds up the (left piece) finger method piece and the (right piece) spatula method which is thicker, how you can easily waste so much more. John prefers the finger one because you have more colour variation on there. Don't forget you can also use a finger dauber, but you must wash it after use, or it will dry solid and be no good to use again. Keep the white card as we will use that later. John is going to use an old dauber which still has a bit of colour on it, so he is not fussed to use it. He has then taken a piece of ridiculously cheap vellum and using the dauber to pick up a colour and go over it, you will see that some of the green is still on the dauber and that has come out onto the paste. Put to one side to dry, if you don't the vellum just rolls up and won't dry flat. Here is a piece he made earlier which has dried and gone all crinkly just like pearlized card, it really is an amazing colour. Q: can you stamp over these, A: yes of course you can with no problems at all, you could also heat emboss it as well. John has got a piece which he adds onto his stamping platform with the magnets to secure it. Then added a flower stamp, inked it up with Versafine, closed the lid and press down, when he opens the lid you have this beautiful floral pearlized piece, it will take a bit

longer to dry, you could add some clear embossing powder over it or leave it to dry naturally and colour afterwards.



- A crafter who has just joined said that they had a job to find us, so John has explained that what we have done is using some new software to make it easier so that we can do this front on, and overhead cameras and we can put graphics and things on, it will make it a lot easier to see especially next week. What that means is that if you go on the John Next Door Official page you will see a post advertising the show, if you click 'interested' it will remind you an hour before that the show is about to start.
- Below is the piece that John made yesterday using the bubbles stencil, which has now dried. He has then taken the piece of white card which has had the paste onto it and has dried out and cut it using the Notched Frame die. Then cut a piece of Coconut White card to 4½" x 4½" and add the separate square die from the set into the centre, taped it down and run through your die cutting machine. Then added the frame onto it so that you can just see the white behind the middle of the frame. Then added foam tape onto the back, remove the yellow backing and we can then adhere over the stencilled piece. There are separate instructions already on the group showing how to use the Notch Frames. Then using your large titanium scissors at an angle to undercut the excess behind the frame. I was just thinking you could use the excess stencilled bit as a tag, I wonder if that is what John is going to do. If you add black card behind it you get a completely different look, but we did say we would put lights in, so that is what we will do next.

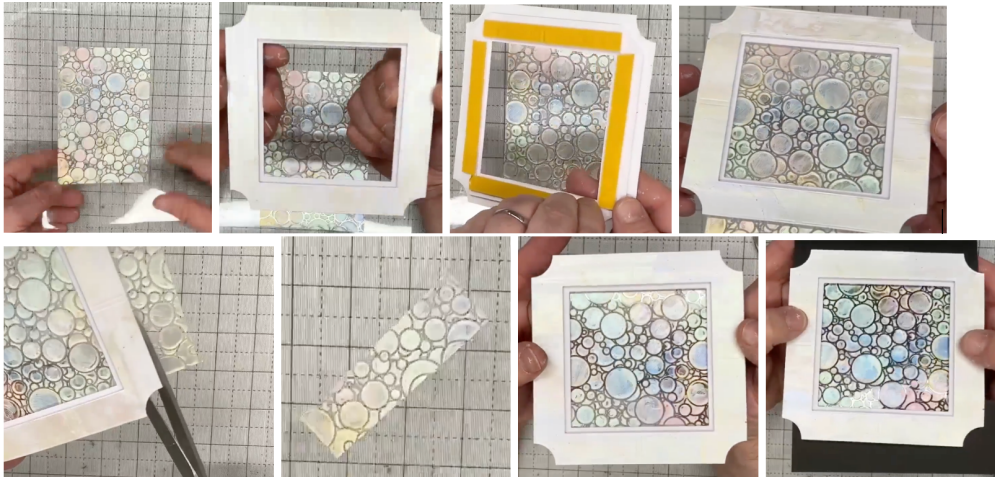

- Bring in your lights, unwind them so that you get all the bends out, then pull the tag out to test the lights. Then make a circle with them then cross over in the middle like a bow, and hold them inside the foam, then carefully turn them over and place onto the black card. If we then take a piece of the pearl vellum that we made earlier and place that behind, it defuses them, and we get a completely different, softer look. We are going to use this, so cut this vellum down to I think it is 4½” or it might be 4¼”. Then we need to use double-sided blue powertape, or a good quality red liner tape, around the outside, then remove the blue covering to reveal the sticky and add the pearl vellum over it. Then use your scissors to cut the end bit off.
- When we then turn it over and position the lights behind it they are nowhere near as obvious, it is a far softer look.

**June’s Tip:** I am going to add something on here that I do when adding lights only because I don’t like to see the wire coming over on the front of the card, so what I do is to take the card blank and I use my pokey tool or my single hole punch to make a hole just where the lights can be threaded right the way through, I can then temporarily add a bit of masking tape to the battery pack. Then I can take the lights and either criss-cross the wire onto the foam tape or around in a circle as long as the lights don’t touch any of the foam and then when I put the card together, all I need to do is to secure the battery pack on the inside of the card blank. I hope you don’t mind me putting this on here John.

- So, to put the lights in we need to add foam tape around the 4 sides again, remove the yellow backing, then hold the battery pack over the top right-hand corner where the foam meets, then all you need to do is to string them from the left foam over to the right foam randomly all the way around trying to make sure that all of the lights are inside the foam and press down. Another of my tips is to keep the yellow backings and put them over the wire temporarily until all the lights are in place, you can then remove them to add the card onto a piece of the black card. Take your scissors and cut off the excess as well as the 4 corners.

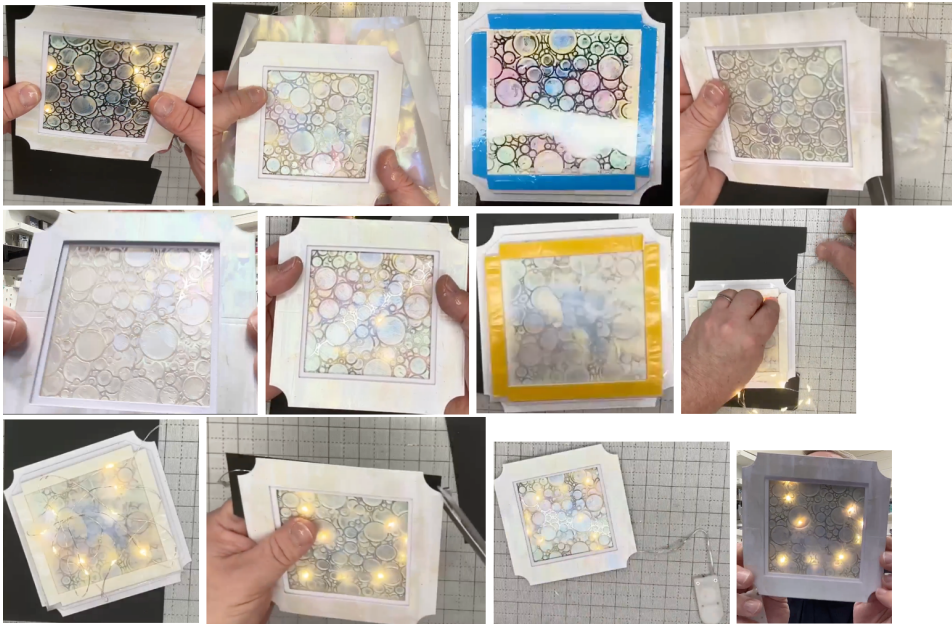

- To make our card up we need to cut a piece of the Coconut white card to 5¼" x 5¼". Then bring back in the white card that you added the paste onto earlier and cut this to 5½" x 5½" , then when you put them together you can see the pearl behind the white. We don't want to waste the pearl so the best thing to do is to cut your frame from the Notch Frame die. Then from the cut outside piece we are going to add a thin line of wet glue to the back of the white and add onto this cut outside bit. You can see the reverse and the front in the photos below and nobody know that is not a full piece.



- Then add foam tape onto the back and a bit in the middle and what this does is to help to secure the tiny frame piece. Then add this onto your top folding card. Then take the main front piece and add wet glue onto the back and add this onto your card front.



- We are then going to make our flowers; it is a little bit more difficult than you would normally do, so take the flower die and on the front rub it over with a tumble dryer sheet, then place this face down onto the left over vellum and tape it down. However the chances of this die cutting in the normal way is quite remote, so take a scrap pieces of 250gsm/300gsm long card and place this behind your piece with the die onto it and then fold the excess piece over, then you can run that through your die cutting machine, this may be harder than normal if you are using a manual die cutting machine, if you have an electric one it would be much easier. You can then see when you look at the back of the plate that it has cut out all of the flowers. If you use a pokey tool from the back of the plate you will make a hole in the vellum, so turn the plate over and use the 4-in-1 pokey tool to gently push on the end of a petal and once you have a couple of the petals loose take the wedge end of your pokey tool and put that behind the petal and you will find that the petal comes out, you may find that they come out easier because of the tumble dryer sheet which removes any residue from the die.



- When it comes to shaping each petal you need to hold the middle of the petal with one hand which is very important, and with the other use the pokey tool end from the middle and gently pull each petal so they have a slight curve, then fold each one in towards the middle.
- Then add a dab of glue glaze into the middle of one petal and offset another of the same size onto it.
- For the centres, these are a little bit more delicate, so try and get them out of the die in one piece, then turn it over onto your moulding mat and take your ball tool and gently go around the edges to shape it, you will find that it will crack as you're doing it but don't worry because we can take your silicone glue and add a small blob onto a cocktail stick, you can then use this as a handle to add onto the centre of our flower.



- The next thing to do is to open the card up so that you can tape down the battery pack onto the inside of the card. Normally you would do this with powertape but for speed John is using Sellotape.
- We can then use our silicone glue onto a cocktail stick and add to the back of each flower, then position the 3 sizes of flowers onto the bottom-right notch corner to hide the wire and another one onto the top right-hand corner of the frame.



The card below is using black vellum to create a fabulous different card made exactly the same way as the white card and using the same colours of paste. You will see how it reacts in a different way. Then another white version. The end piece is on Black Vellum which John made on the Live Shopping channel. John will make this into a card in the morning.



Here is one of the Hat Boxes that we will be making on the morning of the 27 February work shop in Farnborough, info above. In the afternoon we will be making something completely different.



The JND Box Kit is only going to be available from 3 places, they are 'Live Shopping VIP', Craft Stash, and selected supermarkets and WHS retailers. On Live Shopping the price is £14.99 which is fixed by Practical Publishing. On Live Shopping there will be a bundle at £19.99 which will give you 2 packets of matching embellishments and a download of all of the papers, which are John's original papers, not what have been changed for the magazine. Then on Tuesday John will announce all the details of what is coming up next week.

I hope you have enjoyed these instructions.