

JND504 - Charlies Notched Frame - by John Lockwood



Instructions by June Smith

John has created a 'You Tube Video' dated 6th February 2025, where he demonstrates using the new JND504 Charlies Notched Frame, dies shown below, which is the latest release in the FrameMaker Series. I would advise that you visit it as well as following these instructions.

Information:



JND504 Charlies Notched Frame

Die 1 – Main FrameMaker Notched Corner (It is a notched corner going into a notched corner giving you a $\frac{3}{4}$ " frame all the way round)

Die 2 – 5 are 4 decorative panels that fit inside the main frame.

Die 6 – Central sort of Tag with a looped Infinity design which matches with the Infinity dies that we did

Die 7 – Plain rounded corner die

Die 8 – is a smaller version of die 6

Die 9 – A central Infinity panel, which would patinate all the way through.

Materials

6" x 6" White Top Folding Card Blank

JND504 Charlies Notched Frame (9)

PCD226 Notched Rectangles (20) – coming out very soon

Essential Coconut White Card

Craft Artist Warm Tones Canvas Card – Deep Pink Colours

JND508 – Handy Sentiment Stamps using 'Happy Birthday'

Versafine Black Ink Pad
 CT9023 Crafts Too Precision Press Stamping Block
 Die Cutting Machine
 CA Glue Gel & Cocktail Stick
 CA Glue Glaze
 3M Spray Adhesive
 Small Black Pearls
 2mm Foam Tape
 Craft Kit

Method:

- Take your Coconut White card and CA low tack tape and tape down die no 1 towards the top, then add dies 2-5 into the 4 corners and tape them down and run through your die cutting machine, keep the centre white piece for later. Then using the Canvas dark Pink card cut out just die no 1 which is the frame. That then fits exactly behind the white patterned frame. All you do then is to add spray glue onto the back of the white frame and add this onto the pink (or you could use glue glaze).

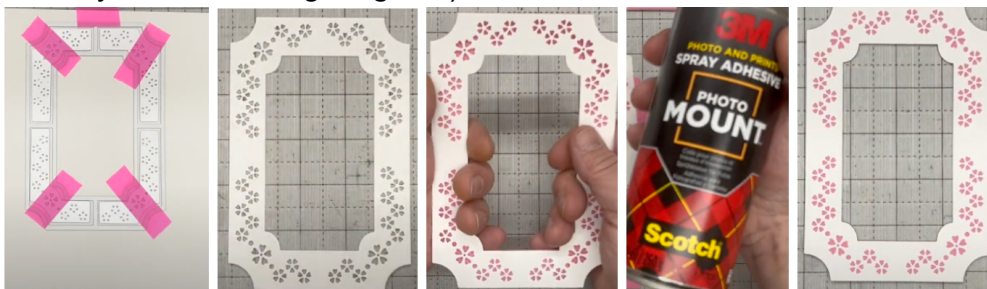

- Add 2mm foam tape onto the back of the frame. Then take a lighter pink canvas card and cut this to 5¾" x 4⅛" then add the frame onto it and add a piece of the repositionable tape onto the top. We are then going to take 2 of the floral corners and ape the design so that one corner is taped down inside the bottom left-hand corner, then repeat with another corner taped down inside the top corner. Then remove the white frame and run the taped dies through your die cutting machine.

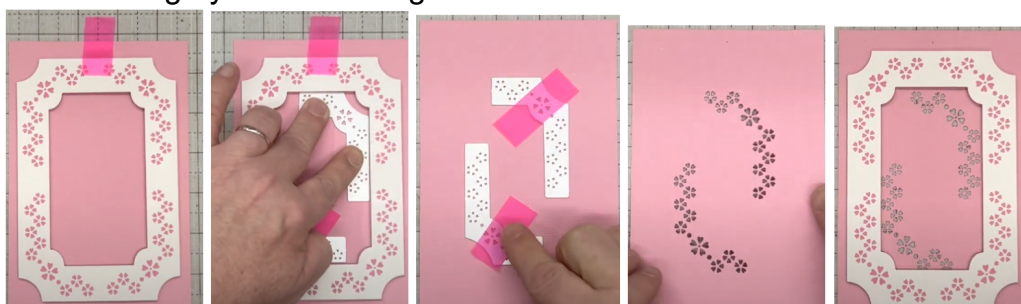

- Then take the white centre section left over from cutting the white frame add a little bit of spray glue onto the pink piece and add it face down on your mat so the sticky is uppermost and then add the white panel into the middle, when you turn it over you can see the white flowers coming through.

- Then remove the yellow backing from the foam tape and add the frame over the pink piece. Take your large scissors and place at an angle so you are able to cut off the bits of pink card showing behind the frame.

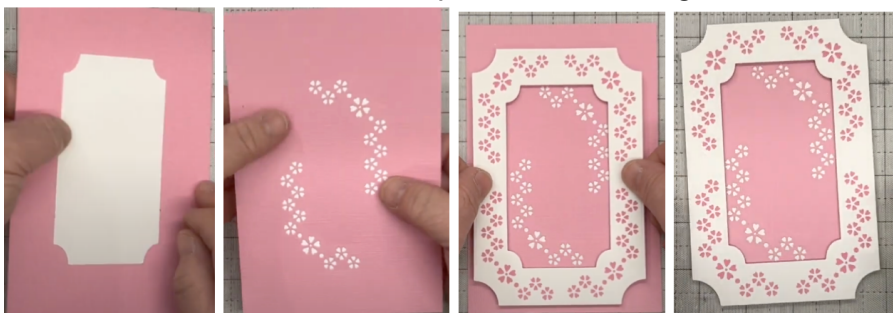

- Then bring in your 6" x 8" top folding white card blank and add a layer of black card. Then John has used the PCD226 Notched Rectangles die set which are mathematically correct every 1/4" as are other nesting dies, the largest is 5 1/2" x 7 1/2" these will be coming out very soon and cut a pink layer and then a white layer and add these to the card blank.
- Bring back in the front piece and added on the back a strip of foam tape where the white meets the pink, remove the yellow backing and added this onto the card layers.



- Then using the scraps of white card cut out die no 6, and from your pink scraps cut out die no 8. Then on the pink piece John is stamping a 'Happy Birthday' sentiment with black ink and using the Precision Press Stamp Block to line the stamp up using the lines on his mat and pressing down. Then take a scrap of card and press down over the black ink just to make sure that it has dried. Turn the piece over and add a small strip of foam tape onto the back and adhere this onto the white.

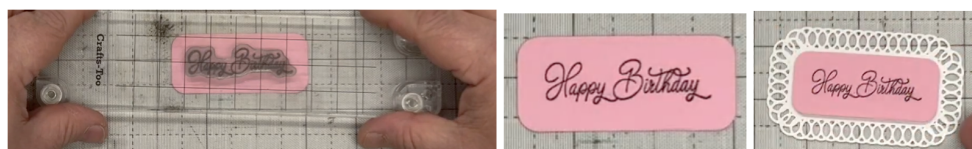

- We then want to add this across the middle of the card and because we have used one layer of foam tape on the frame we need 2 layers of foam tape on the back, remove the yellow backing and add onto the frame using the flowers in the frame as a guide to get it even.

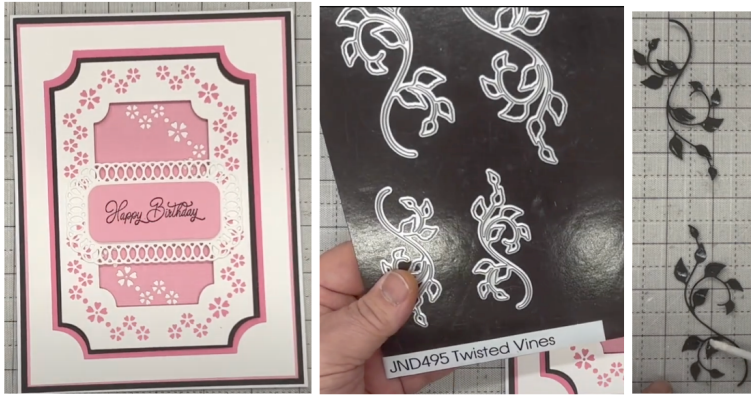

- We now need to decorate the card, we will be using the Shirley Flowers and Twisted Vines dies, there is a separate you-tube on these. Cut the Vine Leaves in black, we are just using 2 of them, then add glue glaze on the back of both of the leaves and the stems and add down the left-hand side of the card so you can poke the stems behind the Happy Birthday sentiment. Then John has taken 3 of the Shirley Flowers cut from the darker pink card and lighter pink card centres which are the same colours as the card and added a small black pearl in the middle, then added these onto the front of the card using your 3D glue gel with a cocktail stick. Bring in your black pearls and using a pair of tweezers add a small black pearl into the centre of the 4 larger flowers on the white frame.



There we have a very delicate card but quite bold with the colour choices



Your creation is now complete. I hope you have enjoyed these instructions.